

---

# Camargue

---

Wood stove

EN 13240

**Model : 134 10 15**

Output : 10 kW

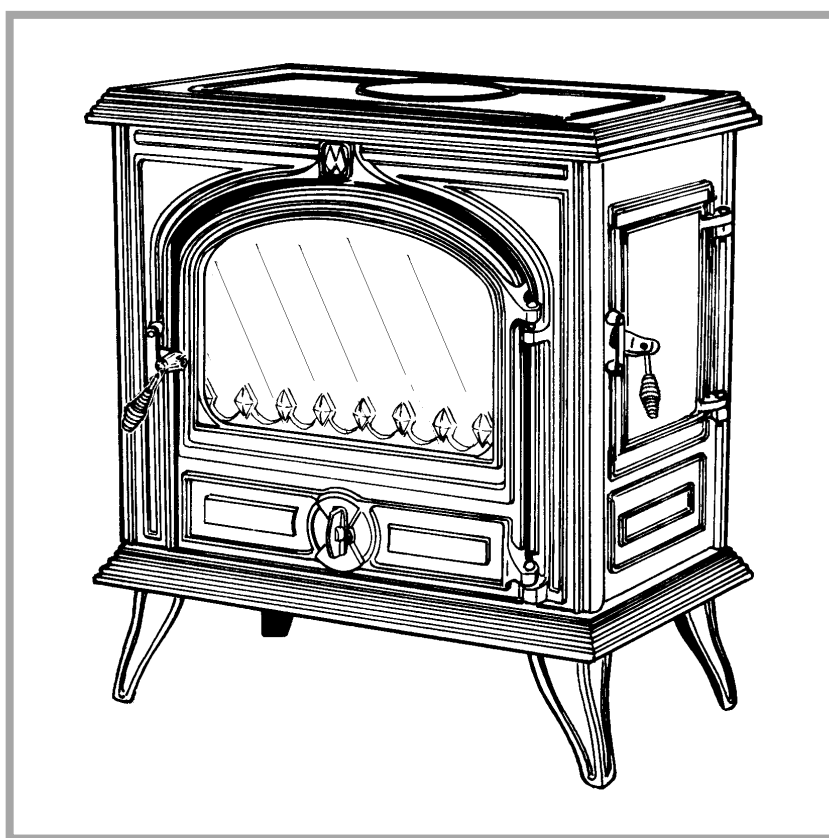

Description of the appliance

Installation instructions

Operating instructions

Spare parts

Warranty certificate

Document n°1141-8 ~ 06/11/2006

FR

NL

EN

**Technical manual**

to be saved

by the user

for future reference



**FRANCO BELGE**

***STAUB FONDERIE***

SARL with the capital of 6 359 540 €

Head Office Address

2, rue Saint Gilles

68230 TURCKHEIM

RCS Colmar

SIREN 444 881 953

Address

Administration and manufacturing

BP 73

59660 MERVILLE (FRANCE)

Telephone : 00 333 28 43 43 00

Fax : 00 333 28 43 43 99

Subject to modifications.

FRANCO BELGE congratulates you on your choice.

FRANCO BELGE, guarantees the quality of its appliances and is committed to meet its customers' needs.

FRANCO BELGE, which can boast a 80-year experience in the industry of heating devices, uses state-of-the-art technologies

to design and manufacture its whole range of products.

This document contains instructions on how to install your appliance and make full use of its functions, both for your comfort and safety.

---

## Contents

---

<b>Description of the unit</b> . . . . .	<b>p. 3</b>
Package . . . . .	Appliance description . . . . . p. 3
Specifications . . . . .	Operating principle. . . . . p. 3
<hr/>	
<b>Installation instructions</b> . . . . .	<b>p. 4</b>
Warning to the user . . . . .	Smoke exit on the top . . . . . p. 6
The room . . . . .	Chimney connector . . . . . p. 6
Flue . . . . .	Fitting of the handle . . . . . p. 6
Assembly of flue spigot and blanking plates . . . . .	Pre-utilisation check . . . . . p. 6
Smoke exit at rear . . . . .	Maintenance of the Chimney . . . . . p. 6
<hr/>	
<b>Instructions for user</b> . . . . .	<b>p. 7</b>
Fuel . . . . .	Re-fuelling . . . . . p. 8
Instructions for use with wood . . . . .	De-ashing . . . . . p. 8
Lighting . . . . .	Maintenance of the stove . . . . . p. 8
Re-fuelling . . . . .	Maintenance of the Chimney . . . . . p. 8
Instructions for use with solid fuel . . . . .	Recommendations . . . . . p. 9
lighting . . . . .	Trouble shooting . . . . . p. 9
<hr/>	
<b>Spare parts</b> . . . . .	<b>p. 11</b>

This appliance is meant to burn wood safely.

## WARNING

**Incorrectly installed, this appliance can be dangerous and possibly cause serious accidents.  
We recommend that you engage the services of a professional engineer for its installation  
and the regular maintenance requirements**

# 1. Description of the unit

## 1.1. Package

- 1 package : Stove

## 1.2. Specifications

<b>Model</b> . . . . .	<b>134 10 15</b>
Nominal Heat Output . . . . . kW	9,9
Heated volume . . . . . m <sup>3</sup>	380
Chimney draft required . . . . . Pa	12
<i>Hearth dimensions</i>	
- Width . . . . . mm	495
- Depth . . . . . mm	255
- Height . . . . . mm	200
<i>Logs dimensions</i>	
- Length maxi . . . . . cm	45
Ash pan capacity . . . . . litre	3
Weight . . . . . kg	115
Mean flue gas temperature . . . . . C°	356
Flue gas mass flow . . . . . g/s	9,6
Efficiency . . . . . %	72,4
Co a 13 % O <sub>2</sub> . . . . . %	0,10
Test fuel mass . . . . . kg	2,3

**Note :** The performances indicated result from tests carried out in accordance with standard EN13240 with logs of Ø 12 of 40 cm and a draught of 12 Pa.

## 1.3. Appliance description

Wood stove, in conformity with EN 13240

- Intermittent burning appliance.
- Detachable flue spigot for rear or top chimney connection.
- Detachable top for easy handling and cleaning (rear smoke exit only).
- Front loading door fitted with large refractory glass panel.
- Side loading door.
- Adjustable air control for controlling the burning rate.
- Large ash-pan.
- Long lasting burning cycle : When the appliance is loaded with à 4,8 kg of dry rate (primary and secondary air inlet closed) with a 5 Pa draught, it runs for 7 hours.

## 1.4. Operating principle

The appliance is designed for operating only with the door closed.  
Heat is mainly diffused by radiation, through the window and body of the appliance. Combustion occurs on the grate, with draught entry through the top of the grate, which assists the combustion of volatile materials helping to keep the glass clean during normal operation.

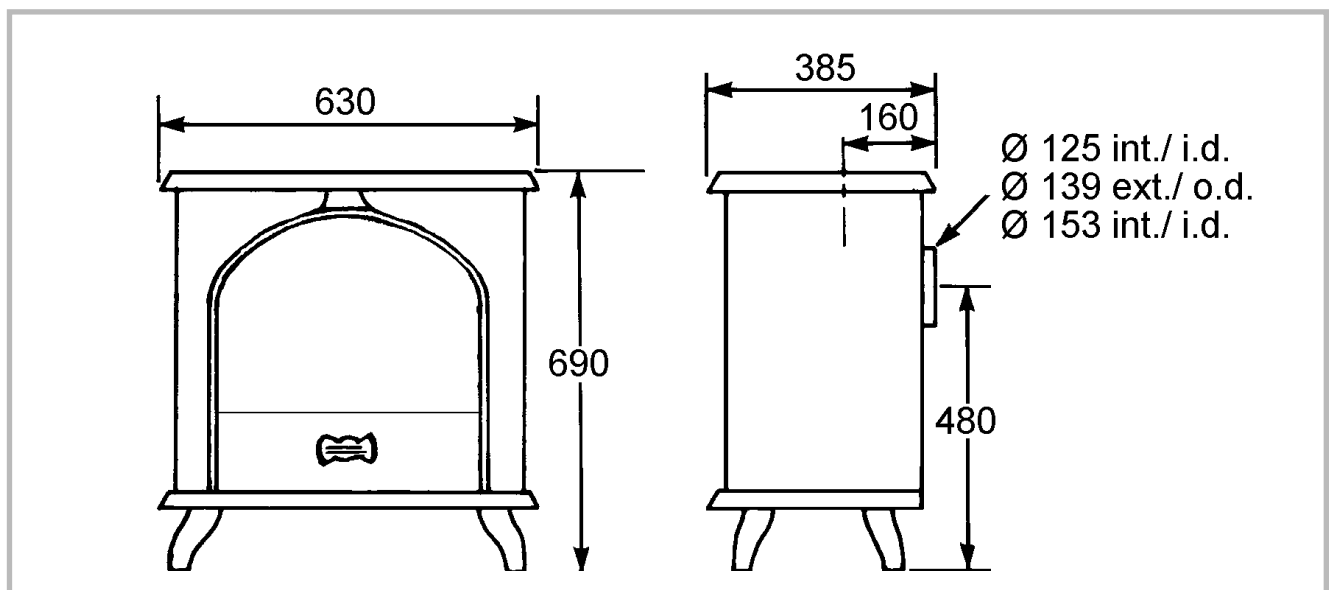

*Figure 1 - Dimensions in mm*

## 2. Installation instructions

### 2.1. Warning to the user

All the local and national regulations, and in particular those relating to national and European standards, must be observed when installing the appliance.

An incorrectly installed heating appliance can cause serious accidents (chimney fires, burning of plastic insulation materials, in partition walls, etc.).

The insulation of both the appliance and the exhaust gas pipe has to be reinforced and done according to the Standards and the Building Regulations for safety reasons.

Failure to respect the mounting instructions leads to engage the responsibility of the one doing the installation.

The manufacturer's responsibility shall be limited to the supply of the equipment.

### 2.2. The room

#### Ventilation :

For satisfactory operation with a natural draught, check that sufficient air for combustion is available in the room.

#### Position of the unit :

For new chimney installations, select a central position within the building, to provide a good heat distribution around the building.

The heat distribution towards the other rooms will be made through the communicating doors. These rooms

must be in negative pressure or must include ventilation gratings.

#### Floor and walls :

Make sure that the floor can support the weight of the appliance, its surroundings and the hood. In the contrary the floor needs to be reinforced with a concrete screed to distribute this load.

Make sure there are not combustible or covered with combustible material.

Otherwise it must necessary to install a non-combustible protection.

There must be a clearance of at least 150 mm at each side of the appliance and at the back of the appliance from a non-combustible wall.

This distance must be extended to a minimum clearance of 400 mm from any combustible materials.

This measurement may be reduced to a minimum gap of 50 mm when the non-combustible wall is at least 200 mm thick.

There should ideally be a minimum gap of 400 mm at the right hand side of the stove, this will ensure the best possible access to the loading door.

When using a single wall flue pipe, there must be a clearance (A) of at least three times its diameter (B) from any combustible materials.

If the appliance has to be located in an opening, this distance must be extended to a minimum clearance (A) of 450 mm from the pipe or the stove body to any combustible materials.

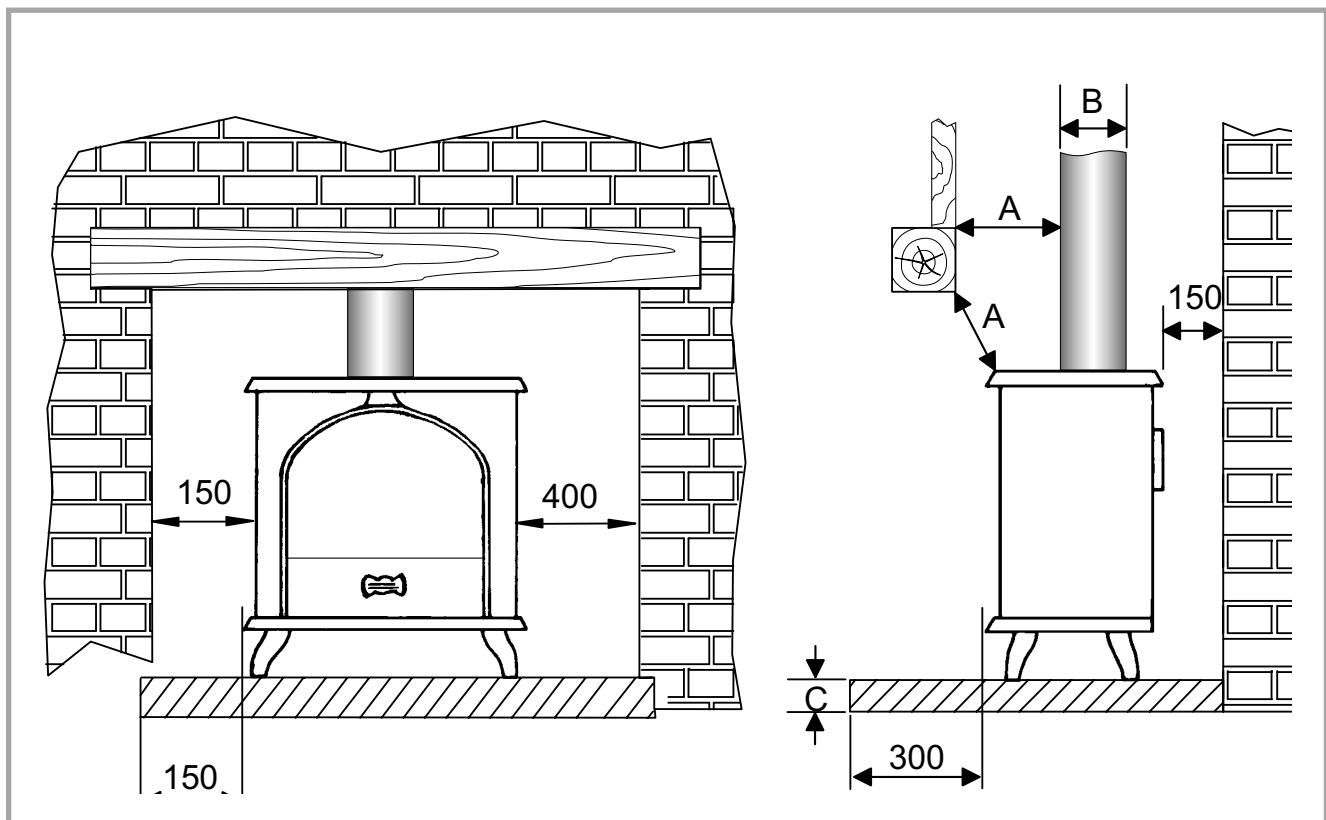

Figure 2 - Minimum clearances

## Hearth

The appliance must stand on a fireproof hearth.

It is possible to provide a hearth made of non combustible board/sheet material or tiles at least 12 mm thick.

Constructional hearths should be constructed of solid non combustible material at least 125 mm thick (including the thickness of any non combustible floor under the hearth).

The hearth must protrude at least 400 mm in front of the stove and 150 mm each side.

If the hearth is constructed on timber, there must be a clearance of at least 250 mm from the timber to the top surface of the hearth.

When using a single wall flue pipe, there must be a clearance (A) of at least 450 mm from any combustible materials (timber mantel, girder).

See section J of the Building regulations.

## 2.3. Flue

The chimney must comply with Current Building Regulations. If in doubt, consult your Dealer or local Building Inspector.

### Existing flue

- The flue must be in good condition and must provide sufficient draught.
- The flue must be suitable for the installation of solid fuel burning appliances and comply with Current Building Regulations.
- The flue must be clean. It should be swept to remove soot and dislodge tar deposits.
- The flue must be well insulated. If the flue inner wall surfaces are cold, a good thermal draw is impossible causing condensation problems (tar formation etc) to occur.
- The flue must not be shared with other appliances.
- The chimney must be at least 4.5 m (15 ft high).
- In case of a flat roof or when the roof gradient is lower than 15°, the stack must be 1,2 m (4 feet) high at least.
- If the chimney has any down draught tendency, due to its position in relation to nearby obstacles, an anti-down draught cowl must be installed on the chimney or the chimney height must be increased.
- If the chimney draught is excessive or irregular, a draught stabilizer (barometric damper) must be installed to the connector pipe. It must be visible and accessible.

### Chimney to be built / new flue :

- The flue must not be supported by the stove.
- Consult a chimney specialist for advice on suitable flue systems for solid fuel appliances.

## 2.4. Assembly of flue spigot and blanking plates

For the flue collar (303860), the stove is supplied with a connection flue spigot with an inner diameter of 125 mm and an outer diameter of 139 mm.

For the flue collar (303826), the stove is supplied with a connection flue spigot with an inner diameter of 153 mm.

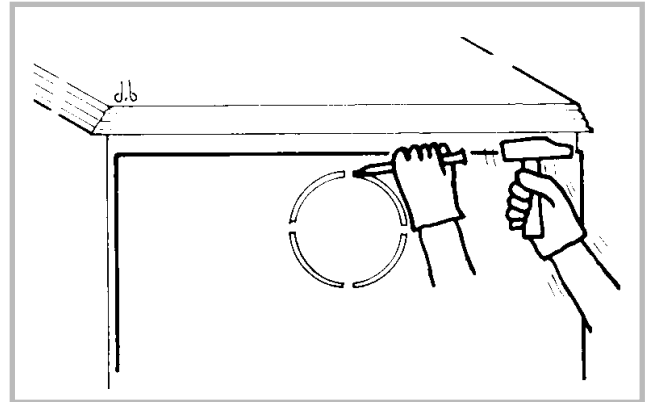

Figure 3 - Removing blanking plate on rear heat shield

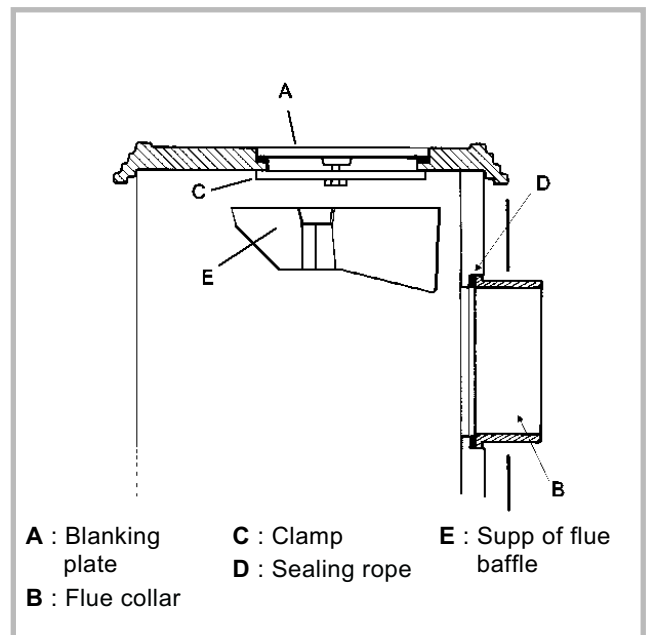

Figure 4 - Smoke exit at rear

## 2.5. Smoke exit at rear

### Figure 4

- Check that the blanking plate and the clamp are fixed to the cast iron top.
- Lift the cast iron top from the stove.
- Remove the internal baffle and the rear heat shield (# 56 & 27, fig. 8, page 12).
- Fix the sealing rope in the groove and fit the flue spigot, ensuring there is a good seal.
- Replace the internal baffle and re-fit the cast iron top.
- Remove the cut-out in the rear heat shield and re-fit.

## 2.6. Smoke exit on the top

**Figure 5**

- Remove the supplement of flue baffle.
- Lift the cast iron top from the stove.
- Remove the blanking plate and the clamp.
- Fit the sealing rope in the groove and attach the flue spigot and the supplementary baffle A using the three bolts and washers supplied.
- Remove the internal baffle and the rear heat shield.
- Position the sealing rope in the groove on the rear aperture of the stove and fit the blanking plate and the clamp.
- Replace the internal baffle, the supplement of flue baffle and the cast iron top.

## 2.7. Chimney connector

**The connection to flue must be carried out according to local building regulations.**

- The appliance must be installed as close as possible to the chimney.
- The connector pipe must be approved for installation with combustion products (either 24 ga. Black painted or blued steel or 316 grade 20 ga. Stainless steel or 1 mm vitreous enamelled steel).
- Pipe diameter must not be less than the appliance spigot diameter. If there is no other solution, the reduction can not be more than one diameter lower than the flue spigot and be situated as distant as possible from the flue connection of the appliance.
- The connection can be either vertical or horizontal. For horizontal connections, avoid right angle bends.
- The joint between the connection pipe and the stovepipe, and the flue, must be leak tight.
- The connection pipe and any draught stabiliser must have access for cleaning.
- The spigot should be connected to a minimum of 125 mm flue system and in that case the appliance is capable of burning untreated wood and recommended solid fuels.

## 2.8. Fitting of the handle

In order to avoid the damaging of the threading, first put the handle in operating position then screw it into the tapping of the lock (fig. 6).

## 2.9. Pre-utilisation check

Check the condition of the filler seals, that the door closes correctly, that the window is not damaged, that the smoke passages are not obstructed by pieces of packaging or removable parts. All removable parts, fuel retainer, oscillating grate, baffle, must be correctly installed.

**Note :** if it acts of a ceramics braid, it is consumable and thus brought to be changed by the user.

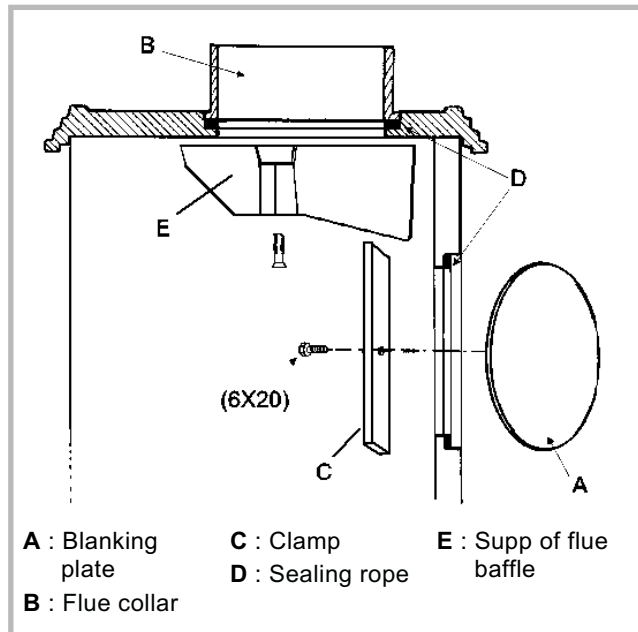

*Figure 5 - Smoke exit on the top*

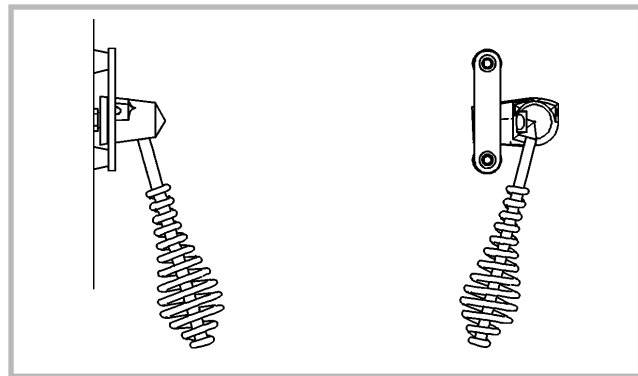

*Figure 6 - Fitting the handle*

## 2.10. Maintenance of the Chimney

**Very important :** In order to avoid any incident (chimney fire, etc...), maintenance tasks must be carried out regularly. If the appliance is regularly used, the chimney should be swept several times per year, together with the stovepipe connection section.

**If the chimney catches fire, you must cut off the flue draught, close the doors and windows, hatches and keys, remove the embers from the stove, stop up the connection hole with wet cloths and call the Fire Brigade.**

**DO NOT OPEN THE DOOR OF THE APPLIANCE (OR AIR INLET) UNDER ANY CIRCUMSTANCES**

Chimney condition should be checked at least once per year by a professional engineer.

## 3. Instructions for user

The manufacturer will not be responsible for damages on parts of the appliance due to the use of prohibited fuel or due to an alteration of the appliance or its installation.

**Only use replacement parts supplied by the manufacturer.**

**All the local and national regulations, and in particular those relating to national and European standards, must be observed when installing the appliance.**

**Don't run the stove in mild weather with coal ! Under certain circumstances (e.g. fog and repeated thaw) the chimney will not draw sufficiently well and thus be at the origin of asphyxia.**

### 3.1. Fuel

**This appliance is not an incinerator.**

**Recommended fuel : Wood**

- Use hard wood logs, which have been cut for at least two years and stored, under shelter (Humidity < 20 %).
- Hardwood has a higher calorific value per cu metre (oak, ash, maple, birch, elm, beech, etc.).
- Large logs must be split and cut to a usable length, before being stored in a sheltered and ventilated place.

**Recommended fuel : Solid fuels**

Smokeless fuels, including coolite nuts, phurnacite, ancit and extracite.

**Not recommended as fuel :**

- "green wood". Green or damp wood reduces stove efficiency and soils the glass, the internal walls and the flue (soot, tar, etc.).

- "used timbers". Burning treated wood (railway sleepers, telegraph poles, offcuts of plywood or chip board, pallets, etc.) quickly clogs the flue ways (soot, tar, etc.), pollutes the environment (pollution and smell, etc.) and cause the fire to burn too quickly and overheat.

"Green wood" and "recovered wood" can eventually cause a chimney fire.

Prohibited fuel : Homefire and any form of bituminous coal or petroleum based coke.

### 3.2. Instructions for use with wood

#### 3.3. Lighting

**Figure 7**

- Slide the top air control (# B1) to the right. Open the lower spin wheel (# C1).
- Lay firelighters or rolled up newspapers on the grate with a reasonable quantity, if necessary, of dry kindling wood. Place 2 or 3 small logs on top.
- Light the newspaper or firelighters using a long taper and close the door.
- When the fire is burning fiercely, add further logs of a diameter up to 10 cms.
- When the stove body is very hot, close the lower spin wheel.
- The burning rate can now be lowered by moving the top air control to the left.

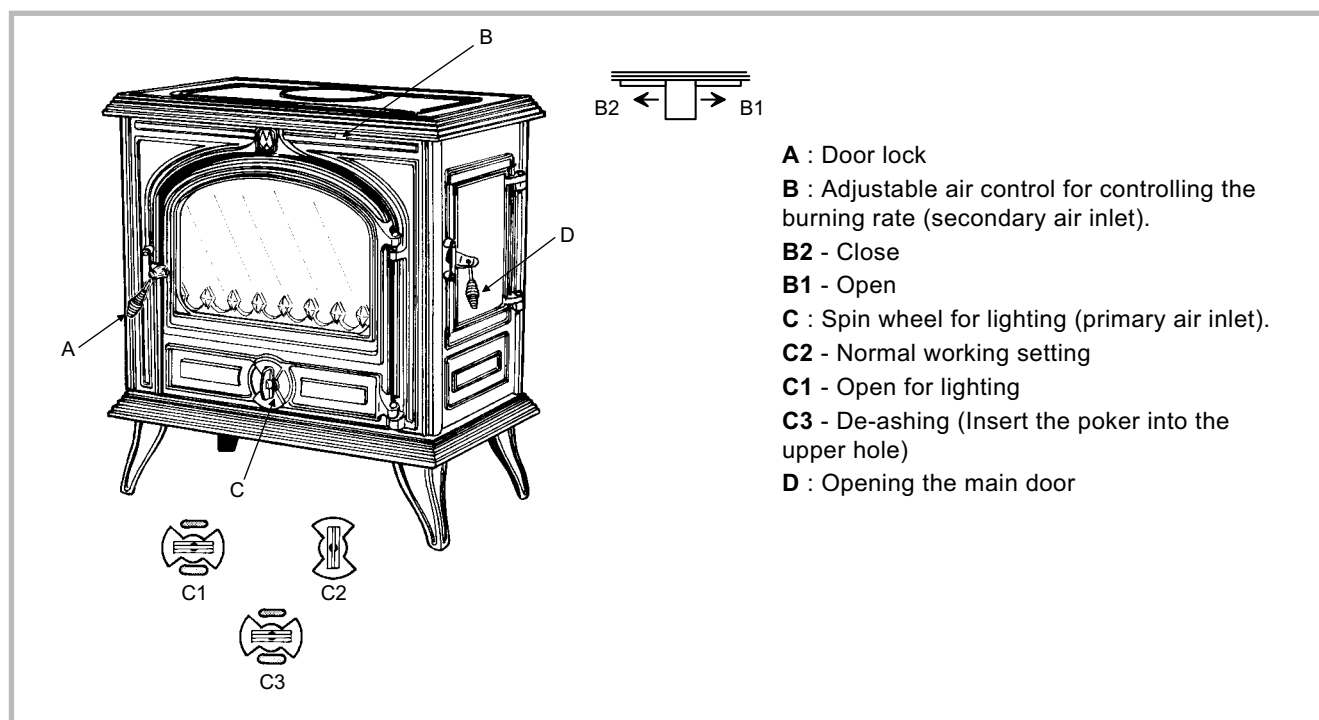

*Figure 7 - Operating devices*

### 3.4. Re-fuelling

**The appliance must function door closed and top plate correctly set up.**

**The burning rate** can be adjusted by the air control flap (# B Fig. 7). Experience will show you which settings are best for your situation. The lighting flap must be closed (# C2 Fig. 7)

- The airwash system works with the top airslide. When the top airslide is full open the system works at its strongest efficiency.
- The more closed down the airslide is, the less effective the airwash will be ( when shut down completely, the airwash system can not function )

**Loading the fuel :**

- It is advisable to wait for the fire to be reduced to hot embers before re-loading. The door should also be opened slowly when re-loading.
- The minimum reloading interval for nominal heat output is 1.5 hours.
- For a briskly burning fire, there should always be at least two logs in the fire. The fire will burn better if there are several logs.
- For a slower burning fire (for example, at night), select larger logs.
- Close the loading door.

Open the lighting flap for a while (# C1 Fig. 7).

### 3.5. Instructions for use with solid fuel

#### 3.6. lighting

- Slide the top air control (# B1) to the right. Open the lower spin wheel.
- Lay firelighters or rolled up newspapers on the grate with a reasonable quantity, if necessary, of dry kindling wood. Place a small quantity of solid fuel on top.
- Light the newspaper or firelighters using a long taper and close the door.
- When the fire is burning fiercely, add further fuel.
- When the stove body is hot, close the top air control by sliding to the left.
- The burning rate can now be adjusted by rotating the lower spin wheel.

#### 3.7. Re-fuelling

- Open the lower spin wheel.
- Open the glass door and add fuel.
- Leave the lower spin wheel open for a few minutes to allow the initial volatiles in the fuel to burn.
- Adjust the lower spin wheel to the desired position.

#### 3.8. De-ashing

- Remove ash until glowing ashes start falling into the pan. (# C3, fig. 7, p. 7)
- Ashes must be removed before loading the firebox and when the fire doesn't burn efficiently.
- Ashes must never be allowed to pile up to the grate. The grate would not be cool down and could rapidly be damaged.
- Empty the ashes when the appliance is cold,

- Empty the ashes carefully with regard to the live embers.

*REMEMBER TO BURN SOLID FUEL CORRECTLY, AIR SHOULD BE ALLOWED TO FLOW FROM THE ASH PIT AREA THROUGH THE GRATE AND THROUGH THE FUEL. IF THE GRATE OR ASH PAN ARE CONGESTED, THE PERFORMANCE WILL BE EFFECTED.*

If burning solid fuel, always empty the ash pan at least once a day or whenever it is full of ashes. Never allow the ashpan to overfill allowing ash to be in contact with the underside of the grate. If this condition is allowed, the grate will wear out pre-maturely.

### 3.9. Maintenance of the stove

- The appliance must be cleaned regularly , together with the connecting pipe and the flue pipe.
- Remove all deposits from the combustion chamber and clean the grate area.
- Cleaning of the glass door can be done with a soft cloth dampened with water and vinegar or potassium ; this must be done when the appliance is cold ; then rinse with clear water. Do not use abrasive cleaners.
- The "vitroc ceramic" glass will resist to temperatures of up to 750 C. Should the glass break due to misuse, it must be replaced by the manufacturers own product.
- All the casing parts can be cleaned using a soft cloth either dry, or slightly damp. In case of condensation or water splashes clean the parts before they dry out.
- Check that there are no obstructions before relighting after a long period of disuse.
- The appliance must not be used with a flue serving several appliances.
- To maintain the grates ventilation free of any obstruction.

**Warning :** The appearance of cracks when burning the enamelled units is quite usual and tends to disappear when the appliance is cooling down. It should not be considered as a defect but rather as a patina of the enamel which does not affect its quality nor its service ability.

### 3.10. Maintenance of the Chimney

**Very important :** In order to avoid any incident (chimney fire, etc...), maintenance tasks must be carried out regularly. If the appliance is regularly used, the chimney should be swept several times per year, together with the stovepipe connection section.

**If the chimney catches fire, you must cut off the flue draught, close the doors and windows, hatches and keys, remove the embers from the stove, stop up the connection hole with wet cloths and call the Fire Brigade.**

**DO NOT OPEN THE DOOR OF THE APPLIANCE (OR AIR INLET) UNDER ANY CIRCUMSTANCES**

Chimney condition should be checked at least once per year by a professional engineer.



### 3.11. Recommendations

- The stove may still be hot even when fire has burnt out.
- This room heater is an appliance producing heat and may cause severe burns if touched.

**KEEP CHILDREN AWAY.**

### 3.12. Trouble shooting



: This sign means that you should ask for a qualified engineer to do the work.

<i>Situation</i>	<b>Probable causes</b>	<b>Corrective action</b>
<i>Fire difficult to start. Fire goes out.</i>	<b>Wood green... or too damp.</b>	- Use hard wood logs, which have been cut for at least two years and stored, under a ventilated shelter.
	<b>Logs are too big.</b>	- To light the fire, use small, very dry twigs. To maintain the fire, use split logs.
	<b>Poor quality wood.</b>	- Use hardwood that have a higher calorific value per cu metre (Yoke-elm, oak, ash, maple, birch, elm, beech, etc.).
	<b>Not enough air.</b>	- Open air control. - Open the outside fresh air inlet grid.
	<b>Insufficient draught.</b> <input checked="" type="checkbox"/>	- Check that the flue is not obstructed, sweep it if necessary. - Seek advice from a chimney specialist.
<i>Fire burns too quickly.</i>	<b>Too much draught.</b>	- Partially close the air control.
	<b>Excessive draught.</b> <input checked="" type="checkbox"/>	- Install a draught stabiliser to the connector pipe.
	<b>Poor quality wood.</b>	- Do not continuously burn small wood, sticks, bundles, carpentry offcuts (plywood, pallets), etc.
<i>Smokes when lighting up.</i>	<b>Flue duct is cold.</b>	- Burn paper and kindling wood to increase heat.
	<b>Room is in decompression (negative pressure).</b>	- In houses equipped with mechanical ventilation, partly open a window until the fire is well established.
<i>Smokes while burning.</i>	<b>Insufficient draught.</b> <input checked="" type="checkbox"/>	- Seek advice from a chimney specialist. - Check that the flue is not obstructed, sweep it if necessary
	<b>Down draught.</b> <input checked="" type="checkbox"/>	- Install an anti-down draught cowl.
	<b>Room is in decompression (negative pressure).</b> <input checked="" type="checkbox"/>	- In houses equipped with mechanical ventilation, an outside air intake must be installed for the chimney.
<i>Low heat output.</i>	<b>Poor quality wood.</b>	- Use the recommended fuel.
	<b>Poor mixing of the convection air.</b>	- Check the air flow system (air inlet, piping, air outlet). - Check that the next rooms are equipped with ventilation grids to help out the hot air circulation.



## 4. Spare parts

When ordering spare parts, specify **the stove type** and **serial number**, including the **colour** index (on the guarantee or identification plate), the **name** of the part and **the part number**.

Example : Wood stove "Camargue", ref. 134 10 15, colour Y, Top plate 302141 77

A = 134 10 15 Y   B = 134 10 15 L   C = 134 10 15 J   D = 134 10 15 N   E = 134 10 15 Q

N°	Code	Description . . . . .	Type . . . . .	A . . . . .	B . . . . .	C . . . . .	D . . . . .	E . . . . .	Qty
1	100956	Axle . . . . .		A . . . . .	B . . . . .	C . . . . .	D . . . . .	E . . . . .	02
2	110405	Hinge pin . . . . .	6x35	A . . . . .	B . . . . .	C . . . . .	D . . . . .	E . . . . .	02
4	134749	Pin . . . . .	4x20	A . . . . .	B . . . . .	C . . . . .	D . . . . .	E . . . . .	02
5	181632	Adhesive rope . . . . .		A . . . . .	B . . . . .	C . . . . .	D . . . . .	E . . . . .	0,80m
6	158541	Handle . . . . .		A . . . . .	B . . . . .	C . . . . .	D . . . . .	E . . . . .	02
8	162961	Descriptive plate . . . . .		A . . . . .	B . . . . .	C . . . . .	D . . . . .	E . . . . .	01
9	166003	Spring . . . . .	11x15	A . . . . .	B . . . . .	C . . . . .	D . . . . .	E . . . . .	01
12	181614	Ceramic rope . . . . .	d. 9,5 mm	A . . . . .	B . . . . .	C . . . . .	D . . . . .	E . . . . .	0,87m
13	105006	Ceramic rope . . . . .	Ø 15	A . . . . .	B . . . . .	C . . . . .	D . . . . .	E . . . . .	3,14m
14	181604	Ceramic rope . . . . .	10x4	A . . . . .	B . . . . .	C . . . . .	D . . . . .	E . . . . .	1 m
15	188779	Ceramic glass . . . . .		A . . . . .	B . . . . .	C . . . . .	D . . . . .	E . . . . .	01
16	189103	Screw . . . . .	27x8x6	A . . . . .	B . . . . .	C . . . . .	D . . . . .	E . . . . .	01
27	205330	Back panel . . . . .		A . . . . .	B . . . . .	C . . . . .	D . . . . .	E . . . . .	01
28	22120066	Striking plate . . . . .		A . . . . .	B . . . . .	C . . . . .	D . . . . .	E . . . . .	02
29	224022	Ash-pan . . . . .		A . . . . .	B . . . . .	C . . . . .	D . . . . .	E . . . . .	01
32	259015	Fixing plate . . . . .		A . . . . .	B . . . . .	C . . . . .	D . . . . .	E . . . . .	04
33	260537	Heat shield . . . . .		A . . . . .	B . . . . .	C . . . . .	D . . . . .	E . . . . .	01
35	30012159	Right leg . . . . .		A . . . . .					02
35	30012177	Right leg . . . . .			B . . . . .				02
35	30012179	Right leg . . . . .				C . . . . .			02
35	300121EP	Right leg . . . . .					D . . . . .		02
35	300121ER	Right leg . . . . .						E . . . . .	02
36	30021759	Left leg . . . . .		A . . . . .					02
36	30021777	Left leg . . . . .			B . . . . .				02
36	30021779	Left leg . . . . .				C . . . . .			02
36	300217EP	Left leg . . . . .					D . . . . .		02
36	300217ER	Left leg . . . . .						E . . . . .	02
37	30045560	Base . . . . .		A . . . . .					01
37	30045577	Base . . . . .			B . . . . .				01
37	30045579	Base . . . . .				C . . . . .			01
37	300455EP	Base . . . . .					D . . . . .		01
37	300455ER	Base . . . . .						E . . . . .	01
38	30151566	Door lock . . . . .		A . . . . .	B . . . . .	C . . . . .	D . . . . .	E . . . . .	02
39	30174259	Air damper . . . . .		A . . . . .					01
39	30174277	Air damper . . . . .			B . . . . .				01
39	30174279	Air damper . . . . .				C . . . . .			01
39	301742EP	Air damper . . . . .					D . . . . .		01
39	301742ER	Air damper . . . . .						E . . . . .	01
40	30214159	Top plate . . . . .		A . . . . .					01
40	30214177	Top plate . . . . .			B . . . . .				01
40	30214179	Top plate . . . . .				C . . . . .			01
40	302141EP	Top plate . . . . .					D . . . . .		01
40	302141ER	Top plate . . . . .						E . . . . .	01
41	30351059	Loading door . . . . .		A . . . . .					01
41	30351077	Loading door . . . . .			B . . . . .				01
41	30351079	Loading door . . . . .				C . . . . .			01
41	303510EP	Loading door . . . . .					D . . . . .		01
41	303510ER	Loading door . . . . .						E . . . . .	01
42	30371859	Blanking plate . . . . .		A . . . . .					01
42	30371877	Blanking plate . . . . .			B . . . . .				01
42	30371879	Blanking plate . . . . .				C . . . . .			01
42	303718EP	Blanking plate . . . . .					D . . . . .		01
42	303718ER	Blanking plate . . . . .						E . . . . .	01
43	30386059	Flue collar . . . . .	Ø 139	A . . . . .					01
43	30386077	Flue collar . . . . .	Ø 139		B . . . . .				01
43	30386079	Flue collar . . . . .	Ø 139			C . . . . .			01
43	303860EP	Flue collar . . . . .	Ø 139				D . . . . .		01

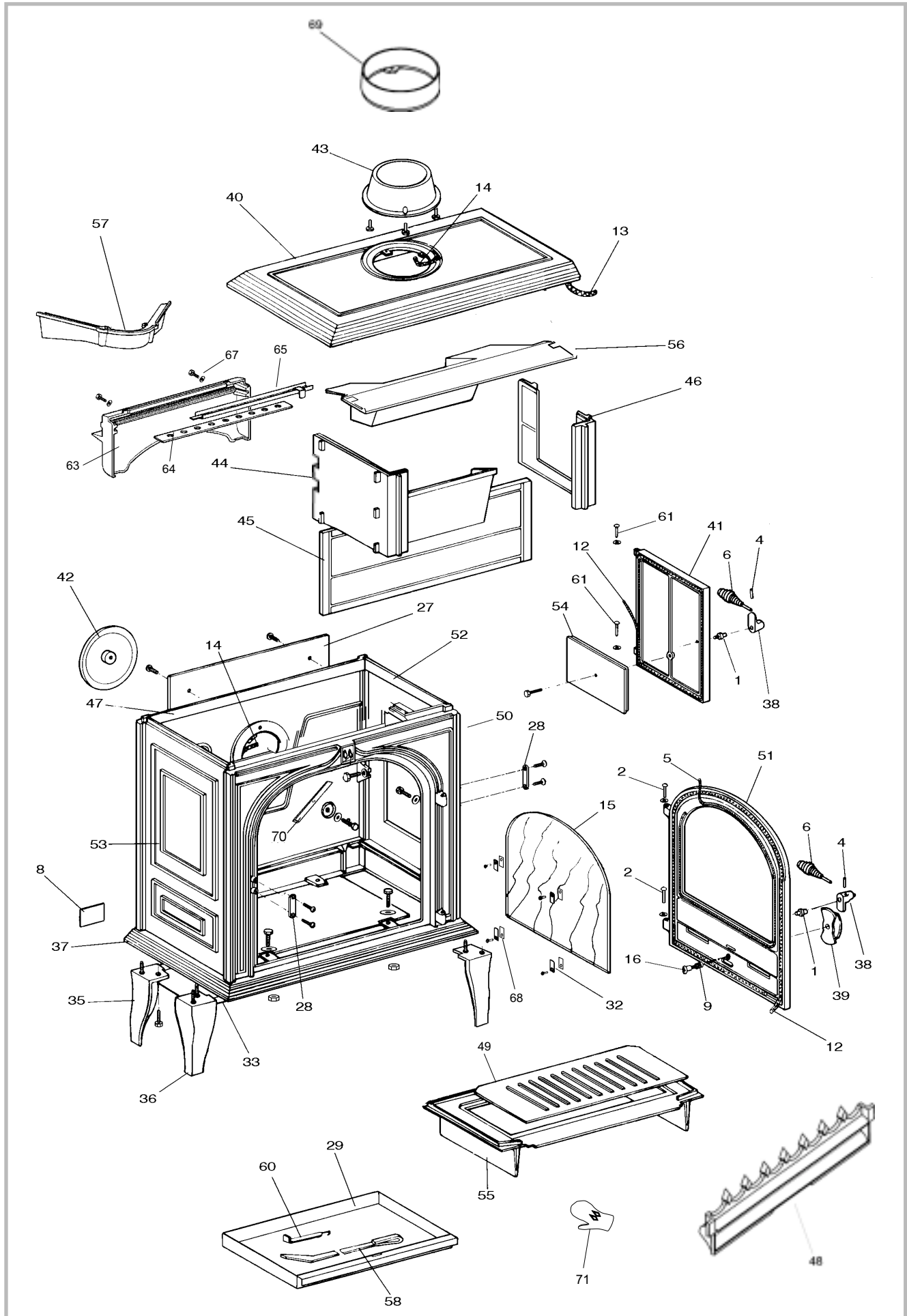

Figure 8 - Spare parts view

A = 134 10 15 Y B = 134 10 15 L C = 134 10 15 J D = 134 10 15 N E = 134 10 15 Q

N°	Code	Description . . . . .	Type . . . . .	A . . . . .	B . . . . .	C . . . . .	D . . . . .	E . . . . .	Qty
43	303860ER	Flue collar . . . . .	Ø 139 . . . . .					E . . . . .	01
44	305009	Wall . . . . .		A . . . . .	B . . . . .	C . . . . .	D . . . . .	E . . . . .	01
45	305114	Back wall . . . . .		A . . . . .	B . . . . .	C . . . . .	D . . . . .	E . . . . .	01
46	305211	Wall . . . . .		A . . . . .	B . . . . .	C . . . . .	D . . . . .	E . . . . .	01
47	306215	Back wall . . . . .		A . . . . .	B . . . . .	C . . . . .	D . . . . .	E . . . . .	01
48	307416	Fuel retainer . . . . .		A . . . . .	B . . . . .	C . . . . .	D . . . . .	E . . . . .	01
49	308710	Grate . . . . .		A . . . . .	B . . . . .	C . . . . .	D . . . . .	E . . . . .	01
50	30985959	Front plate . . . . .		A . . . . .					01
50	30985977	Front plate . . . . .			B . . . . .				01
50	30985979	Front plate . . . . .				C . . . . .			01
50	309859EP	Front plate . . . . .					D . . . . .		01
50	309859ER	Front plate . . . . .						E . . . . .	01
51	30996459	Main door . . . . .		A . . . . .					01
51	30996477	Main door . . . . .			B . . . . .				01
51	30996479	Main door . . . . .				C . . . . .			01
51	309964EP	Main door . . . . .					D . . . . .		01
51	309964ER	Main door . . . . .						E . . . . .	01
51	988798	Complete door . . . . .		A . . . . .					01
51	988800	Complete door . . . . .			B . . . . .				01
51	988891	Complete door . . . . .				C . . . . .			01
51	988858	Complete door . . . . .					D . . . . .		01
51	988993	Complete door . . . . .						E . . . . .	01
52	31072159	Right side panel . . . . .		A . . . . .					01
52	31072177	Right side panel . . . . .			B . . . . .				01
52	31072179	Right side panel . . . . .				C . . . . .			01
52	310721EP	Right side panel . . . . .					D . . . . .		01
52	310721ER	Right side panel . . . . .						E . . . . .	01
53	31081159	Left side panel . . . . .		A . . . . .					01
53	31081177	Left side panel . . . . .			B . . . . .				01
53	31081179	Left side panel . . . . .				C . . . . .			01
53	310811EP	Left side panel . . . . .					D . . . . .		01
53	310811ER	Left side panel . . . . .						E . . . . .	01
54	314607	Inner door . . . . .		A . . . . .	B . . . . .	C . . . . .	D . . . . .	E . . . . .	01
55	319707	Grate support . . . . .		A . . . . .	B . . . . .	C . . . . .	D . . . . .	E . . . . .	01
56	323211	Flue baffle . . . . .		A . . . . .	B . . . . .	C . . . . .	D . . . . .	E . . . . .	01
57	326601	Supplement of flue baffle . . . . .		A . . . . .	B . . . . .	C . . . . .	D . . . . .	E . . . . .	01
58	41550460	Poker . . . . .		A . . . . .	B . . . . .	C . . . . .	D . . . . .	E . . . . .	01
60	80800160	Handle . . . . .		A . . . . .	B . . . . .	C . . . . .	D . . . . .	E . . . . .	01
61	110404	Hinge pin . . . . .	6x30 . . . . .	A . . . . .	B . . . . .	C . . . . .	D . . . . .	E . . . . .	02
63	315601	Air duct . . . . .		A . . . . .	B . . . . .	C . . . . .	D . . . . .	E . . . . .	01
64	442011	Sealing plate . . . . .		A . . . . .	B . . . . .	C . . . . .	D . . . . .	E . . . . .	01
65	613301	Air control flap . . . . .		A . . . . .	B . . . . .	C . . . . .	D . . . . .	E . . . . .	01
66	189788	Screw . . . . .	M6X30 . . . . .	A . . . . .	B . . . . .	C . . . . .	D . . . . .	E . . . . .	02
67	167322	Washer . . . . .	M8 . . . . .	A . . . . .	B . . . . .	C . . . . .	D . . . . .	E . . . . .	02
68	142881	Gasket . . . . .		A . . . . .	B . . . . .	C . . . . .	D . . . . .	E . . . . .	04
69	30382659	Flue collar . . . . .	Ø 153 . . . . .	A . . . . .					01
69	30382677	Flue collar . . . . .	Ø 153 . . . . .		B . . . . .				01
69	30382679	Flue collar . . . . .	Ø 153 . . . . .			C . . . . .			01
69	303826EP	Flue collar . . . . .	Ø 153 . . . . .				D . . . . .		01
69	303826ER	Flue collar . . . . .	Ø 153 . . . . .					E . . . . .	01
70	406816	Clamp . . . . .		A . . . . .	B . . . . .	C . . . . .	D . . . . .	E . . . . .	01
71	134107	Glove . . . . .		A . . . . .	B . . . . .	C . . . . .	D . . . . .	E . . . . .	01



## Guarantee certificate

### Legal guarantee

The specifications, dimensions and information shown on our documents are provided for information purposes only and under no circumstances are binding upon the vendor.

With the aim of constantly improving our equipment, all modifications considered as necessary by our departments may be made without notice.

The provisions of the present guarantee certificate are not excluding or limiting the owner of the equipment's rights, concerning the legal guarantee regarding faults or hidden vices which applies in all circumstances, in the conditions detailed in articles 1641 and following of the civil code, and in the country in which the equipment was purchased.

### Contractual guarantee

Our equipment is guaranteed against faults and hidden vices subject to the following conditions:

- 1) Installation and adjustment of the device by a professional installer.
- 2) Observance of the instructions provided in our technical documents and our installation/adjustment instructions.
- 3) The installation, use and maintenance of the device carried out in conformity with the applicable standards and legislation, and with the indications provided in the technical instructions accompanying the device.

This guarantee covers the replacement, in our factory, of parts recognised as being defective from the outset by

our "Guarantee Inspection" Department. Carriage and labour is at the user's cost. Moreover, if the repair or replacement of parts covered by the guarantee is found to be too costly vis-à-vis the price of the appliance, the decision to replace or repair the appliance will be taken by the vendor.

Our guarantee is for 2 (two) years for all appliances, with the exception of closed combustion fireplace and inserts for which our guarantee is 5 (five) years excluding the following:

- 1) Indicator lights, fuses, electrical elements and fans.
- 2) Parts subject to wear or in contact with high temperatures namely: soles and burner grills, bottom plates baffles, ash pans, paintwork and surface treatments for decorative parts. Also excluded from this guarantee are seals and windows.
- 3) Any damage which may result from the use of the appliance with a fuel other than that stipulated in our instructions.
- 4) Damage occurring to parts caused by elements outside the appliance (down draught, storm damage, damp, abnormal pressure or vacuum, heat shocks, etc.).
- 5) Damage to electrical parts caused by plugging in and using the appliance on a mains system, the voltage of which (measured at the entrance to the appliance) is 10% above or below the nominal voltage of 220 V.

### Exclusion of liability

In the case of a product manufactured at the client's request, under no circumstances may we, as a subcontractor, be considered liable vis-a-vis the client or third parties for defects arising from the installation or a design fault with the item in question.

☒ Name and address of the installer : \_\_\_\_\_  
\_\_\_\_\_

☎ Telephone : \_\_\_\_\_

☒ Name and address of the customer : \_\_\_\_\_  
\_\_\_\_\_

Date of installation : \_\_\_ / \_\_\_ / \_\_\_\_\_

Model of the appliance :  134  10  15

Color :  Y  J  L  N  Q

Serial number : \_\_\_\_\_

- This certificate has to be completed and kept carefully.  
In case of claims, send a copy of this to :

**STAUB FONDERIE, BP 73, 59660 MERVILLE, FRANCE.**