

DAUNTLESS MODEL #1240

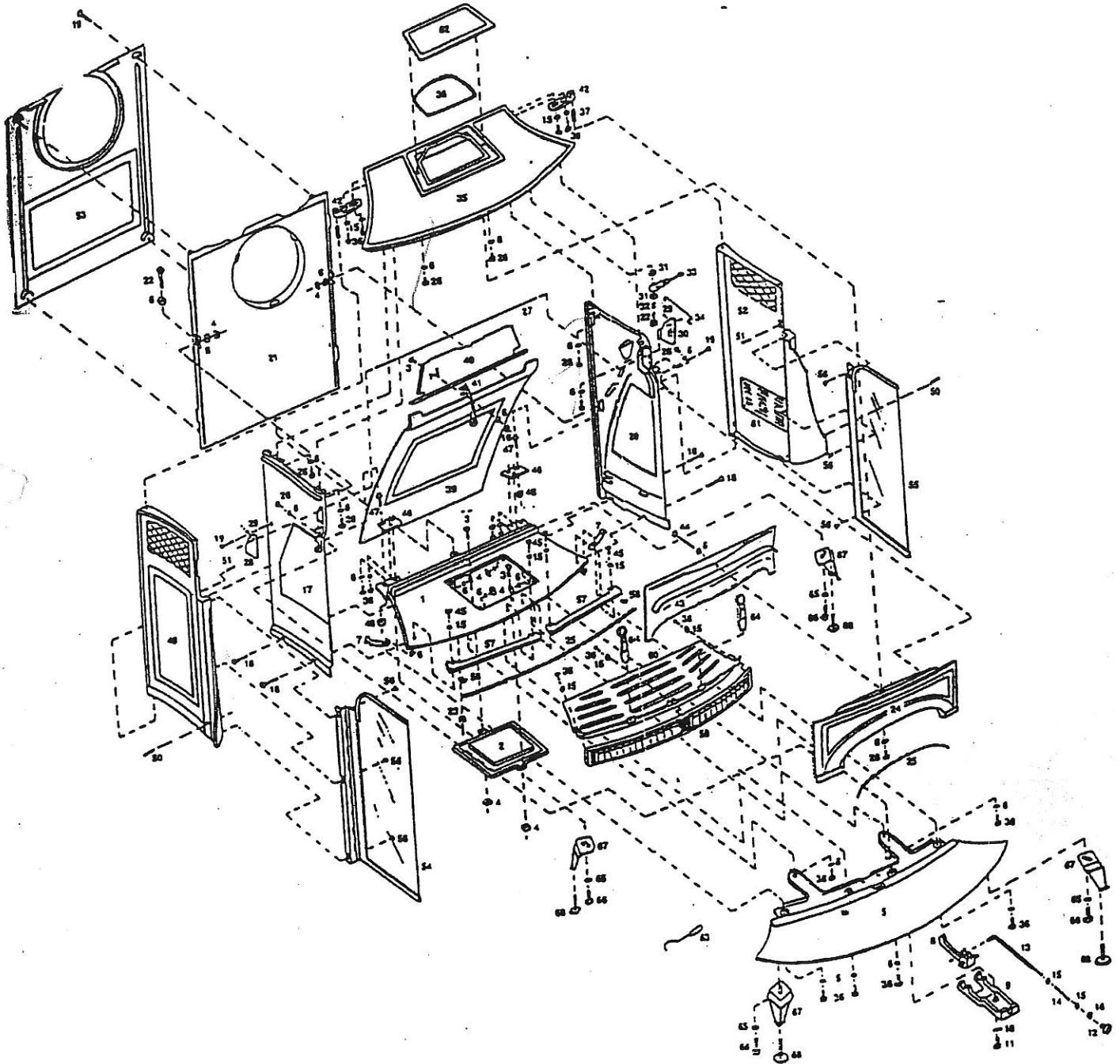

#1240 Dauntless Fireplace

Dauntless

MODEL #'S

1240 DAUNTLESS FIREPLACE

FEATURES:

HAS GLASS DOOR.

MANUFACTURED FROM 10/30/87 THROUGH 3/11/93

DIAGRAM #	ITEM #	PART DESCRIPTION
1	NA-1300900	BOTTOM
2	NA-1300919	GAS COVER PLATE
3	1200881	PH FL HD MACH SCREW 1/4 - 20X 3/4
4	1203329	1/4 - 20 SQUARE NUT
5	NA-1300901	ASHLIP
6	1202474	1/4 STUD WASHER
7	NA-1601395	SIDE DOOR RETAINER
8	NA-1300421	GLASS DOOR LATCH WALRUS
9	NA-1300922	LATCH RETAINER
11	1201326	1/4 - 20 X 1" HEX HEAD CAP
12	NA-1600665	PLASTIC KNOB
13	NA-1600666	KICKER ROD
14	1201850	THERMOSTAT SPRING
15	1202473	1/4 FLAT WASHER
16	1203210	1/4 - 20 HEX NUT
17	NA-1300902	INNER SIDE LEFT > wrong part?
18	1200815	1/4 - 20 X 1 1/2" PHIL FLAT HD MACH
19	1200811	1/4 - 20 X 1/ 1/4" PHIL FLAT HD MACH
20	NA-1300903	INNER SIDE RIGHT
21	NA-1300906	INNER BACK
22	1201378	1/4 - 20 1 1/4 SOCKET SET SCREW
24	NA-1300910	SPANDREL
26	1201374	1/4 - 20 3/4 HED HEAD CAP SCREW
27	NA-1600667	AIR CONTROL ROD
28	NA-1300912	AIR COVER LEFT
29	1200417	1/4 - 20 1/4 SOCKET SET SCREW
30	NA-1300913	AIR COVER RIGHT
32	1201846	TENSION SPRING
33	NA-1300931	AIR CONTROL LEVER > wrong part
34	NA-1600669	AIR CONTROL CONNECTOR
35	NA-1300907	TOP
36	1201372	1/4 - 20 X 5/8 HEX HD CAP S.S
39	1300908	FIREBACK

40	NA-1300907	DAMPER
41	NA-1300934	DAMPER-PULL
42	NA-1300937	ADJUSTABLE TOP-HINGE
43	NA-1300911	FRONT AIR-MANIFOLD
44	1201404	1/4 - 20 X 2 3/4 HEX HEAD BOLT
45	1200894	1/4 - 20 X 1/2 PHIL RD HEAD
46	NA-1300928	HINGE
48	1600418	BOTTOM HINGE PIN
49	NA-1300904	OUTER-SIDE-LEFT
50	1200333	10 - 24 X 5/8 SOCKET SET SCREW
51	1200331	10 - 24 X 3/8 SOCKET SET SCREW
52	NA-1300905	OUTER-SIDE-RIGHT
53	NA-1300914	OUTER-BACK
54	NA-5006085	GLASS-W/BLACK-OXIDE-TRIM-LEFT
	NA-5006086	GLASS-W/BLACK-OXIDE-TRIM-RIGHT
	NA-5006087	GLASS-W/BRASS-TRIM-RIGHT
	NA-5006080	GLASS-W/BRASS-TRIM-LEFT
	NA-5006083	GLASS-W/CHROME-TRIM-LEFT
	NA-5006084	GLASS-W/CHROME-TRIM-RIGHT
56	1200996	10 - 24 X 1/4 PH TRS HD
57	NA-1300917	DOOR-SEAL
58	NA-1301844	LEAF-SPRING
59	NA-1300936	FETTLE
60	NA-1300938	FETTLE-GRATE
62	NA-1300920	GRIDDLE
63	0005814	DAMPER TOOL ASSEMBLY
	NA-1600687	TOOL-HANDLE
	NA-1600693	TOOL-WIRE-FORM
64	1306717	ANDIRON
65	1202488	3/8 FLAT WASHER
66	1201430	3/8 - 16 X 3/4 HEX HEAD BOLT
67	1300663	SHORT LEG
68	1201744	3/8 - 16 1 1/2 HEX HD LVR BLT

ITEMS NOT SHOWN

NA FLUE COLLAR COVER
 NA ALLEN WRENCH
 1600934 L BRACKET
 1203279 5/16 - 18 HEX NUT

 1203305 KEPS NUT 1/4 - 20
 (INNER BACK CLEVIS CONNECTOR)

 1200878 1/4 - 20 X 3/4 PHIL FLAT HD MACH SCREW
 (DAMPER PULL)

 1202058 # 10 X 1/2 PHIL PAN HD SHEET METAL
 (L BRACKET)

ENAMEL PARTS

* PREFIX FOR ENAMEL PARTS

134 MIDNIGHT

139 ANTIQUE BROWN

* 0663 LEG (1) (AVAILABLE IN MIDNIGHT ONLY)
 NA ASH LIP
 * 0904 LEFT OUTER SIDE
 * 0905 RIGHT OUTER SIDE
 * 0907 TOP (AVAILABLE IN MIDNIGHT ONLY)
 * 0910 SPANDREL
 * 0914 BACK

GASKETS

BELOW IS A LIST OF THE TYPE OF GASKET AND THE LENGTH NEEDED ON THE DAUNTLESS.

LOCATION	GASKET SIZE	QUANTITY NEEDED	PART NUMBER
GRIDDLE	3/16" THERMOCORD	3.5'	1203556
SPANDREL	5/16" ARMASEAL	2.0'	1203668
DOOR SEAL	5/16" ARMASEAL	2.0'	1203668
LOAD DOOR	5/16" FIBERGLASS/6 NDLE MED DENS	4.2'	1203588
LEFT DOOR	5/16" FIBERGLASS/6 NDLE MED DENS	4.0'	1203588
RIGHT DOOR	5/16" FIBERGLASS/6 NDLE MED DENS	3.6'	1203588
GRIDDLE	5/16" ARMASEAL	4.0'	1203668
GLASS	EXTRUDED GLASS GASKET	3.0'	1203536

ACCESSORIES

DAUNTLESS GAS LOG KIT PARTS

- 1202473 1/4" WASHER (ANDIRONS)
- 1201372 1/4 - 20 X 5/8 HX HD CAP SCREW (AND)
- NA ~~BACK LOG~~
- NA ~~BURNER PAN ASSEMBLY (NATURAL - CN)~~
- NA ~~BURNER PAN ASSEMBLY (NATURAL)~~
- NA ~~BURNER PAN ASSEMBLY (PROPANE - CN)~~
- NA ~~BURNER PAN ASSEMBLY (PROPANE)~~
- 5007327 COMPLETE KIT HARDWARE PACKAGE
- NA ~~FRONT LOG~~
- NA ~~GLOWING EMBER~~
- NA ~~TOP LOG~~
- NA ~~VALVE ROD ASSEMBLY~~
- NA ~~VALVE SUPPORT BRACKET~~
- NA ~~VERMICULITE~~

HEAT SHIELDS

- NA ~~HARDWARE PACKAGE~~
- SUBSTITUTE:** (4) 1200998 / (4) 1601755 / (4) 1601756
- 1200998 10 - 24 X 1/2 PH TRS HD SCREW (4 USED)

1601755 1.25 SPACER (2 USED)
1601756 2" SPACER (2 USED)
2005096 INSTRUCTIONS

TOP EXIT KIT

NA *SUPERFLUE*
NA *FLUE COVER (2 USED)*
NA *HARDWARE PACKAGE*
2003125 INSTRUCTIONS