

Parts List

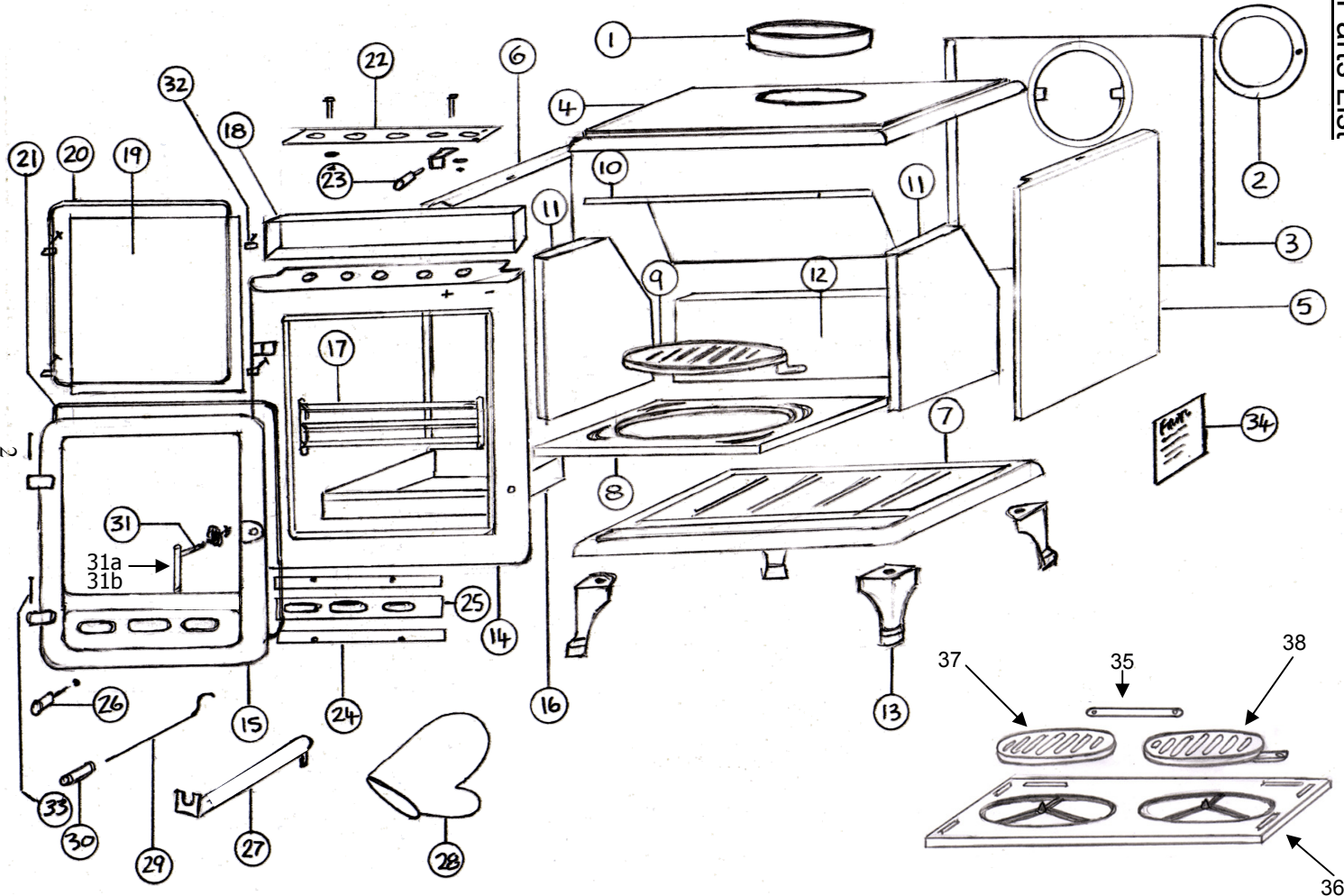

## **Ridlington Parts List**

1	FFX8008	Flue Collar
2	FFX8009	Flue Blanking Plate
3,5,6	FFX8001	Stove Body (Rear,Right,Left Panel)
4	FFX8003	Stove Top Panel
7	FFX8002	Stove Base Panel
10	FFX8007	Stove Baffle Plate
11	FFX8012	Side Brick
12	FFX8013	Back Brick
13	FFX8010	Leg
15	D17C001	Stove Door
16	FFX8014	Ash Pan
17	FFX8011	Front Bar
18	FFX8024	Secondary Air Duct
19	FFX8018	Door Glass
20	FFX8027	Glass Seal
21	FFX8026	Door Seal
22	FFX8023	Secondary Air Slide
23,26,30	FFX022	Primary, Secondary + Riddling Knob Set
24	FFX8021	Locating Strip
25	FFX8020	Primary Air Slide
27	FFX029	Operating Tool
28	FFX1	Mitten
29	FFX015	Grate Riddling Rod
31	FFX017	Door Catch
31a	D11C010-A	Door Handle (Brushed Steel)
31b	D11C010-B	Door Handle (PVD)
32	FFX019	Door Glass Retaining Tabs
33	FFX028	Hinge Pin
34	-	Stove Identification Label (non-replaceable part)
35	FFX8030	Grate Connecting Bar
36	FFX8005	Grate Support Plate
37	FFX8006L	Grate (LH)
38	FFX8006R	Grate (RH)

# Dimensions

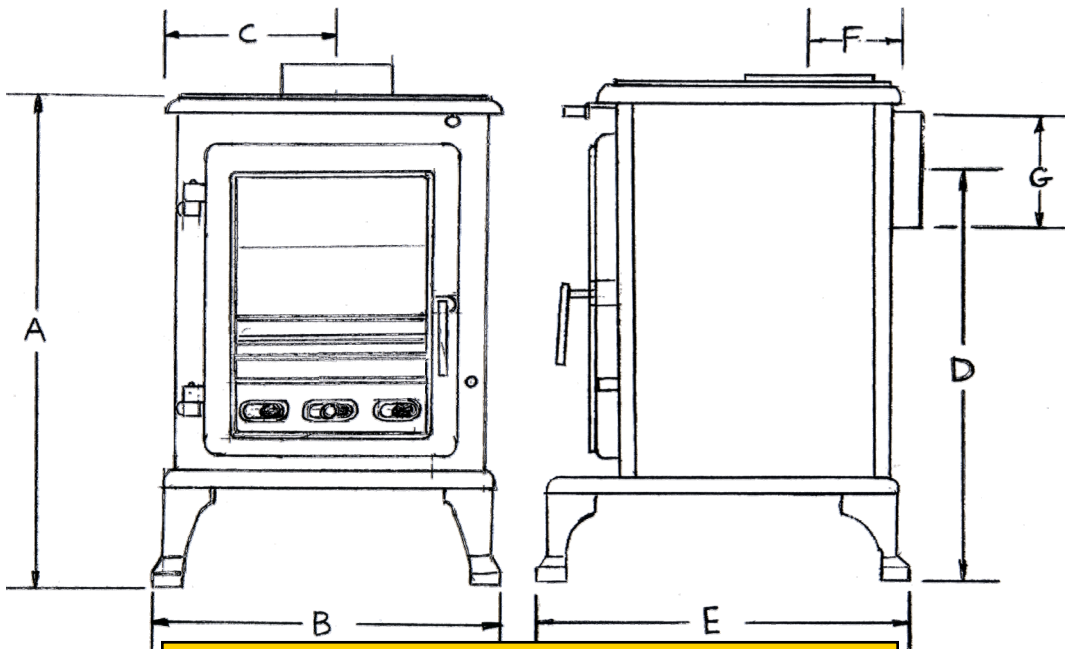

Picture for illustration only - Dimensions are correct

Dimensions, mm	A	B	C	D	E	F	G	Weight	Max Fuel Load Anthracite	Minimum Flue Draught
<b>Ridlington</b>	607	566	283	485	363	140	164	90 Kg	8.64 Kg	12 Pa 0.048 In Wg

Ventilation Requirement: 21.5cm<sup>2</sup> unrestricted free air

<b>Key To Dimensions</b>
A—Height
B—Width
C—Centreline of Flue
D—Height To Centre of Rear Flue
E—Depth
F—Rear to Centre of Top Flue
G—Flue Diameter

<b>Output</b>	<b>Output kW Ridlington</b>	<b>Cycle Hours</b>
Anthracite	8.42	4
Wood Logs	8.9	1
Coal	6.5	4
Peat	8.38	2
Closed Fire Briquettes	8.64	4

Dimensions may vary slightly, the manufacturers reserve the right to adjust them without notice. Outputs stated are under ideal test conditions. Variations will occur due to installation, atmospheric conditions and fuel quality.