

# Spare Parts List

## *Parkray Chiltern 111 Inset & Freestanding*



G.B. Reg. Design No: 1052672

The name "PARKRAY" is a registered Trade Mark.

**IMPORTANT**

SHOULD REPLACEMENT PARTS BE NECESSARY,  
ONLY GENUINE PARKRAY SPARES SHOULD BE USED.

When ordering parts please state :

1. The name of the appliance (PARKRAY Chiltern 36, 66)
2. The Part No. and description overleaf. If a sub-assembly is required, it is sufficient to state the assembly number and title.

*This Parts List confirms with the recommendations made in  
"Guide to Good Practice" issued by The Central Heating Equipment  
Manufacturers and Distributors Consultative Group.*



**Parkray  
Chiltern  
III  
(Inset &  
Freestanding)**

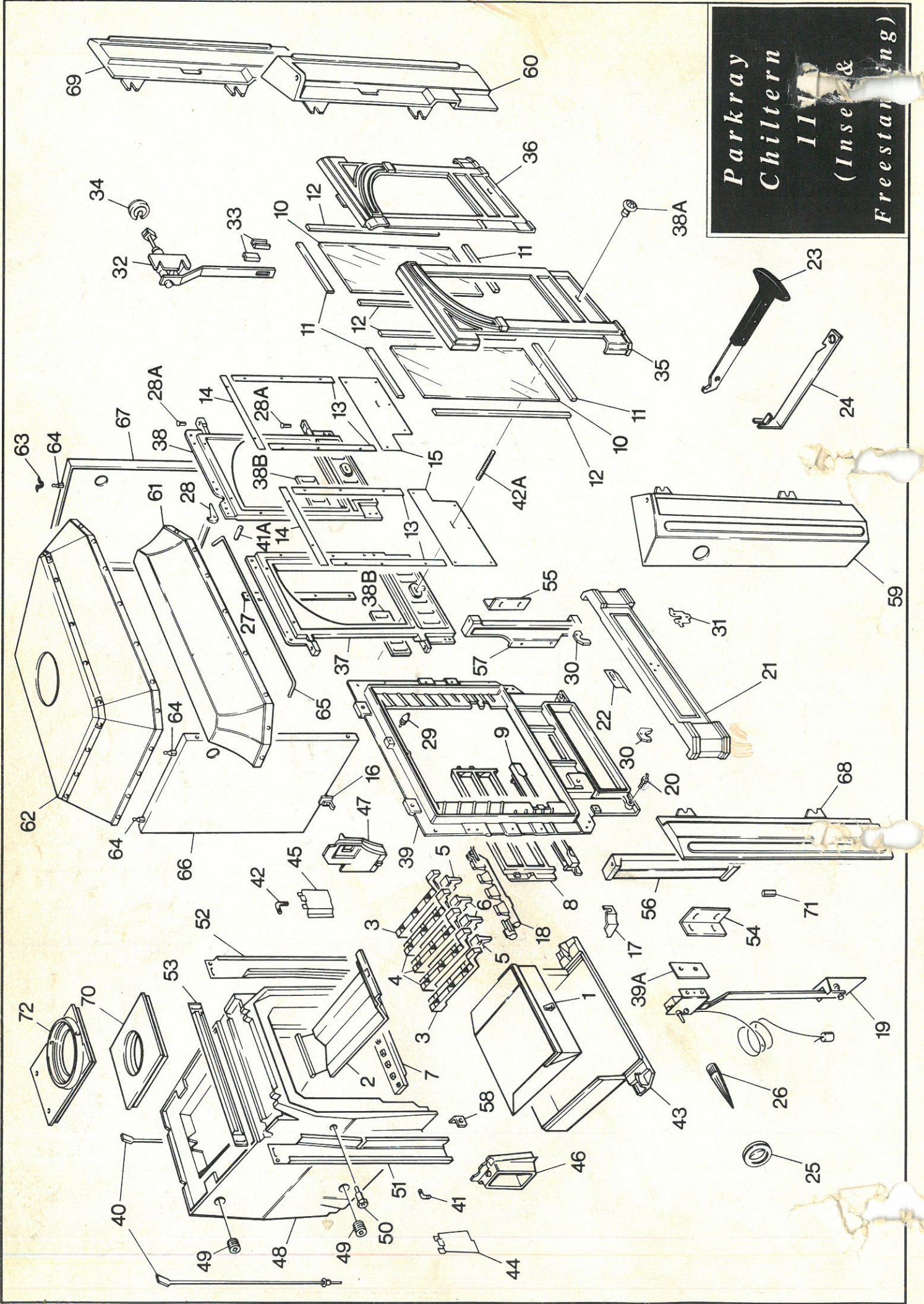



**Parkray  
Chiltern  
III  
(Inset &  
Freestanding)**

