

Håndtak sidedør / handle side door

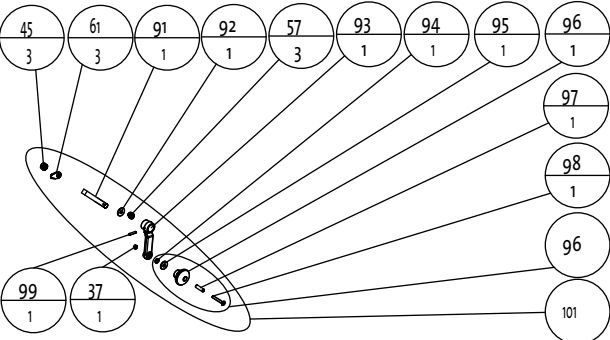

Håndtak askedør res deler / handle ash door spare parts

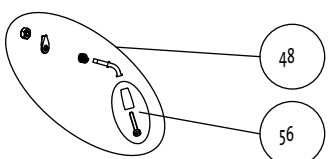

Del-liste/Part list Jøtul F 600

Jøtul AS Fredrikstad, Norway	Drawing no. 3-2715-Po2	Date: March 2004
---------------------------------	---------------------------	---------------------

			Jøtul F 600 Versjon 3		
			Jøtul F 600 BP cat.no. 350775, BBE-cat.no. 350776, OGE-cat.no. 350777, IVE-cat.no. 350778, GRE-cat.no. 350931, BRM- cat. no. 351111, BLM-cat nn.351126		
Pos. No.	Spareparts	Consist of pos no.	Benevnelse	Description	Dim./Spec.
2	155766		Rørrammeholder	Tube frame holder	Cast iron, min.4mm thick
3	154706		Håndtak	Handle	Steel + wood
4			Askehus	Ash house ,	Cast iron, min.4mm thick
	155719	4,5,45,48,56,57,59,61,68,69,72	Askehus komplett BP	Ash house comp. BP	Cast iron, min.4mm thick
	155720	4,5,45,48,56,57,59,61,68,69,72	Askehus komplett BBE	Ash house comp. BBE	Cast iron, min.4mm thick
	155721	4,5,45,48,56,57,59,61,68,69,72	Askehus komplett OGE	Ash house comp. OGE	Cast iron, min.4mm thick
	155722	4,5,45,48,56,57,59,61,68,69,72	Askehus komplett IVE	Ash house comp. IVE	Cast iron, min.4mm thick
	156173	4,5,45,48,56,57,59,61,68,69,72	Askehus komplett GRE	Ash house comp. GRE	Cast iron, min.4mm thick
	156329	4,5,45,48,56,57,59,61,68,69,72	Askehus komplett BRM	Ash house comp. BRM	Cast iron, min.4mm thick
	156547	4,5,45,48,56,57,59,61,68,69,72	Askehus komplett BLM	Ash house comp. BLM	Cast iron, min.4mm thick
5			Askedør BP	Ash door , BP	Cast iron, min.4mm thick
6	153776	2,6	Røyktut BP	Smoke outlet , BP	Cast iron, min.4mm thick
6	153772	2,6	Røyktut BBE	Smoke outlet , BBE	Cast iron, min.4mm thick
6	153774	2,6	Røyktut OGE	Smoke outlet , OGE	Cast iron, min.4mm thick
6	153773	2,6	Røyktut IVE	Smoke outlet , IVE	Cast iron, min.4mm thick
6	153775	2,6	Røyktut , IBE	Smoke outlet , IBE	Cast iron, min.4mm thick
6	156128	2,6	Røyktut , GRE	Smoke outlet , GRE	Cast iron, min.4mm thick
6	156326	2,6	Røyktut , BRM	Smoke outlet , BRM	Cast iron, min.4mm thick
6	156535	2,6	Røyktut , BLM	Smoke outlet , BLM	Cast iron, min.4mm thick
7	10332912		Fyrrest	Fire grate	Cast iron, min.4mm thick
8	10333292		Ben BP	Leg , BP	Cast iron, min.4mm thick
8	10333227		Ben BBE	Leg , BBE	Cast iron, min.4mm thick
8	10333232		Ben OGE	Leg , OGE	Cast iron, min.4mm thick
8	10333229		Ben IVE	Leg , IVE	Cast iron, min.4mm thick
8	10333236		Ben , IBE	Leg , IBE	Cast iron, min.4mm thick
8	10333246		Ben , GRE	Leg , GRE	Cast iron, min.4mm thick
8	10333247		Ben , BRM	Leg , BRM	Cast iron, min.4mm thick
8	10333248		Ben , BLM	Leg , BLM	Cast iron, min.4mm thick
9	10334292		Pyntedeksel side BP	Decorative cover side , BP	Cast iron, min.4mm thick
9	10334227		Pyntedeksel side BBE	Decorative cover side , BBE	Cast iron, min.4mm thick
9	10334232		Pyntedeksel side OGE	Decorative cover side , OGE	Cast iron, min.4mm thick
9	10334229		Pyntedeksel side IVE	Decorative cover side , IVE	Cast iron, min.4mm thick
9	10334236		Pyntedeksel side , IBE	Decorative cover side , IBE	Cast iron, min.4mm thick
9	10334246		Pyntedeksel side , GRE	Decorative cover side , GRE	Cast iron, min.4mm thick
9	10334247		Pyntedeksel side , BRM	Decorative cover side , BRM	Cast iron, min.4mm thick
9	10334248		Pyntedeksel side , BLM	Decorative cover side , BLM	Cast iron, min.4mm thick
10	155702	10,44,45,46,57,60,61,62,63,70,74,88	Dør høyre u/glass,Ver 3 BP	Door right w/o glass, Ver 3 BP	Cast iron, min.4mm thick
10	155704	10,44,45,46,57,60,61,62,63,70,74,88	Dør høyre u/glass Ver 3 BBE	Door right w/o glass, Ver 3 BBE	Cast iron, min.4mm thick
10	155706	10,44,45,46,57,60,61,62,63,70,74,88	Dør høyre u/glass Ver 3 OGE	Door right w/o glass, Ver 3 OGE	Cast iron, min.4mm thick
10	155708	10,44,45,46,57,60,61,62,63,70,74,88	Dør høyre u/glass Ver 3 IVE	Door right w/o glass, Ver 3 IVE	Cast iron, min.4mm thick
10	156180	10,44,45,46,57,60,61,62,63,70,74,88	Dør høyre u/glass Ver 3 GRE	Door right w/o glass, Ver 3 GRE	Cast iron, min.4mm thick
10	156352	10,44,45,46,57,60,61,62,63,70,74,88	Dør høyre u/glass Ver 3 BRM	Door right w/o glass, Ver 3 BRM	Cast iron, min.4mm thick
10	156553	10,44,45,46,57,60,61,62,63,70,74,88	Dør høyre u/glass Ver 3 BLM	Door right w/o glass, Ver 3 BLM	Cast iron, min.4mm thick
11	155703	11,44,46,60,63,70,73,74,88	Dør venstre u/glass, Ver 3 BP	Door left w/o glass, Ver 3 BP	Cast iron, min.4mm thick
11	155705	11,44,46,60,63,70,73,74,88	Dør venstre u/glass, Ver 3 BBE	Door left w/o glass, Ver 3 BBE	Cast iron, min.4mm thick
11	155707	11,44,46,60,63,70,73,74,88	Dør venstre u/glass, Ver 3 OGE	Door left w/o glass, Ver 3 OGE	Cast iron, min.4mm thick
11	155709	11,44,46,60,63,70,73,74,88	Dør venstre u/glass, Ver 3 IVE	Door left w/o glass, Ver 3 IVE	Cast iron, min.4mm thick
11	156181	11,44,46,60,63,70,73,74,88	Dør venstre u/glass, Ver 3 GRE	Door left w/o glass, Ver 3 GRE	Cast iron, min.4mm thick
11	156353	11,44,46,60,63,70,73,74,88	Dør venstre u/glass, Ver 3 BRM	Door left w/o glass, Ver 3 BRM	Cast iron, min.4mm thick
11	156554	11,44,46,60,63,70,73,74,88	Dør venstre u/glass, Ver 3 BLM	Door left w/o glass, Ver 3 BLM	Cast iron, min.4mm thick
12	10388492		Bunn BP	Bottom , BP	Cast iron, min.4mm thick
12	10388427		Bunn BBE	Bottom , BBE	Cast iron, min.4mm thick

		Jøtul F 600 Versjon 3				
		Jøtul F 600 BP cat.no. 350775, BBE-cat.no. 350776, OGE-cat.no. 350777, IVE-cat.no. 350778, GRE-cat.no. 350931, BRM- cat. no. 351111, BLM-cat nn.351126				
Pos. No.	Spareparts	Consist of pos no.	Benevnelse	Description	Dim./Spec.	
12	10388432		Bunn OGE	Bottom , OGE	Cast iron, min.4mm thick	
12	10388429		Bunn IVE	Bottom , IVE	Cast iron, min.4mm thick	
12	10388446		Bunn GRE	Bottom , GRE	Cast iron, min.4mm thick	
12	10388447		Bunn BRM	Bottom , BRM	Cast iron, min.4mm thick	
12	10388448		Bunn BLM	Bottom , BLM	Cast iron, min.4mm thick	
13	10388512		Innerbunn, fremre del	Inner bottom, front part	Cast iron, min.4mm thick	
14	10388612		Innerbunn, bakre del	Inner bottom, rear part	Cast iron, min.4mm thick	
15	10388792		Bakstykke BP	Rear plate , BP	Cast iron, min.4mm thick	
15	10388727		Bakstykke BBE	Rear plate , BBE	Cast iron, min.4mm thick	
15	10388732		Bakstykke OGE	Rear plate , OGE	Cast iron, min.4mm thick	
15	10388729		Bakstykke IVE	Rear plate , IVE	Cast iron, min.4mm thick	
15	10388746		Bakstykke GRE	Rear plate , GRE	Cast iron, min.4mm thick	
15	10388747		Bakstykke BRM	Rear plate , BRM	Cast iron, min.4mm thick	
15	10388748		Bakstykke BLM	Rear plate , BLM	Cast iron, min.4mm thick	
17	10388912		Kanal	Air manifold	Cast iron, min.4mm thick	
18	10389092		Front BP	Front , BP	Cast iron, min.4mm thick	
18	10389027		Front BBE	Front , BBE	Cast iron, min.4mm thick	
18	10389032		Front OGE	Front , OGE	Cast iron, min.4mm thick	
18	10389029		Front IVE	Front , IVE	Cast iron, min.4mm thick	
18	10389046		Front GRE	Front , GRE	Cast iron, min.4mm thick	
18	10389047		Front BRM	Front , BRM	Cast iron, min.4mm thick	
18	10389048		Front BLM	Front , BLM	Cast iron, min.4mm thick	
19	155691		Innerfront	Inner front	Cast iron, min.4mm thick	
20	10389292		Side høyre BP	Side right , BP	Cast iron, min.4mm thick	
20	10389227		Side høyre BBE	Side right , BBE	Cast iron, min.4mm thick	
20	10389232		Side høyre OGE	Side right , OGE	Cast iron, min.4mm thick	
20	10389229		Side høyre IVE	Side right , IVE	Cast iron, min.4mm thick	
20	10389246		Side høyre GRE	Side right , GRE	Cast iron, min.4mm thick	
20	10389247		Side høyre BRM	Side right , BRM	Cast iron, min.4mm thick	
20	10389248		Side høyre BLM	Side right , BLM	Cast iron, min.4mm thick	
21	10389392		Side venstre BP	Side left , BP	Cast iron, min.4mm thick	
21	10389327		Side venstre BBE	Side left , BBE	Cast iron, min.4mm thick	
21	10389332		Side venstre OGE	Side left , OGE	Cast iron, min.4mm thick	
21	10389329		Side venstre IVE	Side left , IVE	Cast iron, min.4mm thick	
21	10389346		Side venstre GRE	Side left , GRE	Cast iron, min.4mm thick	
21	10389347		Side venstre BRM	Side left , BRM	Cast iron, min.4mm thick	
21	10389348		Side venstre BLM	Side left , BLM	Cast iron, min.4mm thick	
22	10389492		Askeleppe front BP	Ash lip front , BP	Cast iron, min.4mm thick	
22	10389427		Askeleppe front BBE	Ash lip front , BBE	Cast iron, min.4mm thick	
22	10389432		Askeleppe front OGE	Ash lip front , OGE	Cast iron, min.4mm thick	
22	10389429		Askeleppe front IVE	Ash lip front , IVE	Cast iron, min.4mm thick	
22	10389446		Askeleppe front GRE	Ash lip front , GRE	Cast iron, min.4mm thick	
22	10389447		Askeleppe front BRM	Ash lip front , BRM	Cast iron, min.4mm thick	
22	10389448		Askeleppe front BLM	Ash lip front , BLM	Cast iron, min.4mm thick	
23	154569	23,71	Topp BP	Top , BP	Cast iron, min.4mm thick	
23	154570	23,71	Topp BBE	Top , BBE	Cast iron, min.4mm thick	
23	154571	23,71	Topp OGE	Top , OGE	Cast iron, min.4mm thick	
23	154572	23,71	Topp IVE	Top , IVE	Cast iron, min.4mm thick	
23	156182	23,71	Topp GRE	Top , GRE	Cast iron, min.4mm thick	
23	156355	23,71	Topp BRM	Top , BRM	Cast iron, min.4mm thick	
23	156556	23,71	Topp BLM	Top , BLM	Cast iron, min.4mm thick	
24			Rørholder øvre høyre	Tube holder upper right	Cast iron, min.4mm thick	

		Jøtul F 600 Versjon 3			
		Jøtul F 600 BP cat.no. 350775, BBE-cat.no. 350776, OGE-cat.no. 350777, IVE-cat.no. 350778, GRE-cat.no. 350931, BRM- cat.no. 351111, BLM-cat nn.351126			
Pos. No.	Spareparts	Consist of pos no.	Benevnelse	Description	Dim./Spec.
25			Rørholder øvre venstre	Tube holder upper left	Cast iron, min.4mm thick
26			Rørholder nedre høyre	Tube holder bottom right	Cast iron, min.4mm thick
27			Rørholder nedre venstre	Tube holder bottom left	Cast iron, min.4mm thick
28	10400018		Inspeksjonsluke	Inspection cover	Cast iron, min.4mm thick
29	155714	29,30,45,50,55,57,61,75,91,92,93,99	Sidedør BP	Side door , BP	Cast iron, min.4mm thick
29	155715	29,30,45,50,55,57,61,75,91,92,93,99	Sidedør BBE	Side door , BBE	Cast iron, min.4mm thick
29	155716	29,30,45,50,55,57,61,75,91,92,93,99	Sidedør OGE	Side door , OGE	Cast iron, min.4mm thick
29	155717	29,30,45,50,55,57,61,75,91,92,93,99	Sidedør IVE	Side door , IVE	Cast iron, min.4mm thick
29	156179	29,30,45,50,55,57,61,75,91,92,93,99	Sidedør GRE	Side door , GRE	Cast iron, min.4mm thick
29	156351	29,30,45,50,55,57,61,75,91,92,93,99	Sidedør BRM	Side door , BRM	Cast iron, min.4mm thick
29	156552	29,30,45,50,55,57,61,75,91,92,93,99	Sidedør BLM	Side door , BLM	Cast iron, min.4mm thick
30	10400212		Brennplate sidedør	Burnplate side door	Cast iron, min.4mm thick
31	10400312		Brennplate venstre	Burnplate left	Cast iron, min.4mm thick
32	10400412		Brennplate bak	Burnplate rear	Cast iron, min.4mm thick
33	10400592		Askeleppe side BP	Ash lip side , BP	Cast iron, min.4mm thick
33	10400527		Askeleppe side BBE	Ash lip side , BBE	Cast iron, min.4mm thick
33	10400532		Askeleppe side OGE	Ash lip side , OGE	Cast iron, min.4mm thick
33	10400529		Askeleppe side IVE	Ash lip side , IVE	Cast iron, min.4mm thick
33	10400546		Askeleppe side GRE	Ash lip side , GRE	Cast iron, min.4mm thick
33	10400547		Askeleppe side BRM	Ash lip side , BRM	Cast iron, min.4mm thick
33	10400548		Askeleppe side BLM	Ash lip side , BLM	Cast iron, min.4mm thick
34	10400616		Ventil	Air valve	Cast iron, min.4mm thick
35	10400712		Hvelv	Baffle plate	Cast iron, min.4mm thick
36	154574	36,89	Toppdeksel BP	Top cover	Cast iron, min.4mm thick
36	154575	36,89	Toppdeksel BBE	Top cover , BBE	Cast iron, min.4mm thick
36	154576	36,89	Toppdeksel OGE	Top cover , OGE	Cast iron, min.4mm thick
36	154577	36,89	Toppdeksel IVE	Top cover , IVE	Cast iron, min.4mm thick
36	156183	36,89	Toppdeksel GRE	Top cover , GRE	Cast iron, min.4mm thick
36	156354	36,89	Toppdeksel BRM	Top cover , BRM	Cast iron, min.4mm thick
36	156555	36,89	Toppdeksel BLM	Top cover , BLM	Cast iron, min.4mm thick
36	351105		Kleber toppdeksel ekstrautstyr	Soap stone top cover extra	Soap stone
37			Mutter rustfri	Nut stainless	M6
38			Skrue sekskant rustfri	Screw hexagon stainless	M6x25mm DIN 933 A4
39			Skrue sekskant	Screw hexagon	M6x50
40			Skrue krave	Screw collar hexagon	M6x25mm
41			Skrue krave	Screw collar hexagon	M6x16mm
42			Skrue selvgjengende	Screw selfthread	M6
43			Skrue krave	Screw collar hexagon	M6x10 mm
44			Skrue krave	Screw collar hexagon	M6x12mm
45			Mutter	Nut Hexagon	M10
46			Skrue panh. (front dør)	Screw panh. (front door)	M6x8 DIN 934
47			Skive	Washer	Ø6x12x0,5 mm
48	220852		Låsebolt askedør	Latch bolt ash door	Ø10mm Steel
48	155713	45,48,56,57,59,61	Håndtak askedør komplett	Handle ash door complete	
49			Skrue innv. sekskant	Screw allen	M8x25mm
50			Skrue seksk rustfri	Screw hexagon stainless	M6x16mm DIN 933 A4-80
51			Skrue krave	Screw collar hexagon	M8x12mm
52			Skrue krave	Screw collar hexagon	M8x16mm
53			Skrue krave	Screw collar hexagon	M8x30mm
54			Mutter krave	Nut collar hexagon	M6
55	120004		Skive	Washer	Ø6.4x18x1.6mm
56	155738	56,59	Treknott askedør	Wooden knob ash door	Hard wood

		Jøtul F 600 Versjon 3			
		Jøtul F 600 BP cat.no. 350775, BBE-cat.no. 350776, OGE-cat.no. 350777, IVE-cat.no. 350778, GRE-cat.no. 350931, BRM- cat. no. 351111, BLM-cat nn.351126			
Pos. No.	Spareparts	Consist of pos no.	Benevnelse	Description	Dim./Spec.
57	126164		Fjær for låsskrue	Spring for latch bolt	2mm Stainless steel
58	127075		Hengselubb front/sidedør Sort kromat	Hinge pin front/side door , Black cromat	ø6mm
58	125960		Hengselubb forniklet	Hinge pin front/side door, nickel cromat	ø6mm
59			Skruv sylindrehode	Screw syl. Head	M6x60
60			Pakning (høyre dør mot front)	Gasket (right door to front)	LD -375-2 Ø9,5(3/8")x900mm
60			Pakning (venstre dør motfront)	Gasket (left door to front)	LD -375-2 Ø9,5(3/8")x900mm
61	128011		Stengejern	Latch	3mm Stainless steel
62	128359		Låsskrue	Latch bolt	ø10mm Steel
63	128361		Glassklips	Glass clip	1mm Stainless steel
64	128362		Askeskuff	Ash pan	1mm steel plate
65	222673		Hendel for luftventil	Handle for air vent	ø5mm Steel
68	128408		Hengselbolt, askedør	Hinge pin, ash door	ø8mm Steel
69			Pakning (Askedør)	Gasket (ashdoor)	LD -250-2 Ø6,4(1/4")x1100mm
69	410761		Pakning (askedør)	Gasket (ash door)	LD-375-2 Ø9,5(3/8")x1100mm(5000mm)
70			Pakning (glass)	Gasket (glass)	LD-250 Ø6,4(1/4")x1050mm
71			Pakning (topp)	Gasket (top)	LD -375-2 Ø9,5(3/8")x2100
72			Pakning (askehus)	Gasket (ash house)	LD-250 Ø6,4(1/4")x1300
73			Pakning (venstre dør mot midten)	Gasket (left door middle)	LD-250 Ø6,4(1/4")x410mm
74	128934		Hylse for hengsel	Sleeve for door hinge	ø10xø6,2x10mm
75			Pakning (sidedør)	Gasket (side door)	LD-375-2 Ø9,5(3/8")x1400mm
76			Pakning (røyk tut)	Gasket (Smoke outlet)	LD-250 Ø6,4(1/4")x930mm
77			Rør nr 1 fra front	Tube first from front	ø22,2mm Stainless steel tube
78			Rør nr 2 fra front	Tube second from front	ø22,2mm Stainless steel tube
79			Rør nr 3 fra front	Tube third from front	ø22,2mm Stainless steel tube
80			Rør nr 4 fra front	Tube forth from front	ø22,2mm Stainless steel tube
82	154330		Skjermpate under USA	Bottom heatshield USA	ø0,9mm steel plate
82	129192		Skjermpate under EUR	Bottom heatshield EUR	ø0,9mm steel plate
83			Skjermpate røykuttak	Heatshield top exit	ø0,9mm steel plate
84	154329	83,84	Skjermpate bak+ røykuttak	Rear heatshield+ top exit	
84			Skjermpate bak	Rear heatshield	ø0,9mm steel plate
85	129284		Luftbegrenser	Air restrictor	1,0mm steel plate
86	129506		Isolasjonsmatte	Insulation blanket	720x360x13mm
87	128357		Glass høyre	Glass right	4mm ceramic glass
87	128419		Glass venstre	Glass left	4mm ceramic glass
88	220120		Hengsel ny	Front door hinge	4mm steel + ø6steel pins
89			Pakning (toppdeksel)	Gasket (top cover)	LD -360 Ø8,7(11\32")x1050mm
90	220270		Låsering Ø6 X Ø12 X 6 mm	Shaft collar Ø6 X Ø12 X 6 mm	Ø6 X Ø12 X 6 mm Steel
91	220853		Låsebolt sidedør	Latch bolt side door	ø10,0mm steel
92	117587		Skive	Washer	Ø10,5xØ25x1,5
93			Klinke forniklet	Latch nick chromed	Cast iron, min.4mm thick
93			Klinke Sort	Latch nick black	Cast iron, min.4mm thick
94			Skive	Washer	Ø6,4xØ12,5x1,6
95	124853		Skive klingerit	Washer, insulating	ø22xø8,2x2mm
96			Treknott sidedør	Wooden knob side door	Hard wood
96	151991	37,94,95,96,97,98	Treknott med smådeler	Wooden knob w\small parts	
97	126229		Distansehylse sidedør	Distance sleeve for side door	ø8xø6x27,5mm
98			Skruv pan hode	Skruv pan head	M6x40
99	117733		Spennstift	Pin	ø5x24
100	154401	24,25,26,27,39,55,77,78,79,80	Luftkammer komplett	Air chamber complete	
101	155711	37,45,57,61,91,92,93,94,95,96,97,98,99	Håndtak sidedør komplett BP	Handle side door complete BP	
101	155712	37,45,57,61,91,92,93,94,95,96,97,98,99	Håndtak sidedør komplett, forniklet	Handle side door complete nickel plated	
102	221032		Adapter lufttilførsel	Adater outside air	0,75mm Alum \ aluzn

