

4.Spare parts

When ordering spare parts, specify the stove **type** and **serial number**, including the **colour** index (on the guarantee or identification plate), the **name of the part** and the **part number**.

Example : Wood stove "**Monte Carlo**", ref. 134 12 07, color **Y**, top plate **352177 EF**

A = 134 12 07 **Y** ; **B** = 134 12 07 **L** ; **C** = 134 12 07 **B** ; **D** = 134 12 07 **E** ; **E** = 134 12 07 **P** ; **F** = 1341207 **C**

N°	Code	Désignation	Type	A	B	C	D	E	F	Qté
1	100939	Axle		A	B	C	D	E	F	02
2	101067	Cam pin		A	B	C	D	E	F	01
3	101073	Sliding door axle		A	B	C	D	E	F	02
4	101074	Axle		A	B	C	D	E	F	01
5	105632	Firebrick		A	B	C	D	E	F	01
6	105634	Firebrick		A	B	C	D	E	F	01
7	105635	Firebrick		A	B	C	D	E	F	01
8	110403	Hinge pin	6x35	A	B	C	D	E	F	02
9	105006	Gasket	Ø 15	A	B	C	D	E	F	2,53 m
10	101811	Ring		A	B	C	D	E	F	01
11	616121	Circulation duct		A	B	C	D	E	F	02
12	134253	Bushing		A	B	C	D	E	F	02
13	142881	Gasket		A	B	C	D	E	F	02
14	181630	Gasket		A	B	C	D	E	F	1,5 m
15	142898	Gasket		A	B	C	D	E	F	02
16	158637	Handle		A	B	C	D	E	F	01
17	161027	Touch-up paint	(J)		B					01
17	161047	Touch-up paint	(B)			C				01
17	161061	Touch-up paint	(E)				D			01
17	161025	Touch-up paint	(L)					E		01
17	161059	Touch-up paint	(C)						F	01
18	166003	Spring	11x15	A	B	C	D	E	F	03
19	175013	Suppl. flue baffle		A	B	C	D	E	F	0
20	179628	Regulator shaft		A	B	C	D	E	F	01
21a	181604	Ceramic rope	10x4	A	B	C	D	E	F	0,5 m
21b	181604	Ceramic rope	10x4	A	B	C	D	E	F	0,5 m
22a	181632	Gasket	Ø 6	A	B	C	D	E	F	1,75 m
22b	181632	Gasket	Ø 6	A	B	C	D	E	F	0,30 m
23	181633	Gasket	Ø 10	A	B	C	D	E	F	1,05 m
24	188890	Refractory glass	540x333	A	B	C	D	E	F	01
25	189103	Screw	27x8x6	A	B	C	D	E	F	04
26	189104	Screw	6x22	A	B	C	D	E	F	02
27	189141	Screw		A	B	C	D	E	F	01
28	189142	Screw		A	B	C	D	E	F	01
29	222583	Flue baffle		A	B	C	D	E	F	01
30	222620	Suppl. flue baffle		A	B	C	D	E	F	00
31	224058	Ash-pan		A	B	C	D	E	F	01
32	261010	Heat shield		A	B	C	D	E	F	01
33	228629	Square		A	B	C	D	E	F	01
34	231303	Square		A	B	C	D	E	F	01
35	237429	Reducing plate		A	B	C	D	E	F	02
36	259015	Fixing plate		A	B	C	D	E	F	04
37	262615	Heat shield		A	B	C	D	E	F	01
38	265605	60 Knob		A	B	C	D	E	F	01
39	270416	Air control flap		A	B	C	D	E	F	01
40	277609	Knob		A	B	C	D	E	F	01
41	406816	Clamp		A	B	C	D	E	F	01
42	900992	Door lock		A	B	C	D	E	F	01
43	300140	MK Leg							F	04
43	300140	RH Leg						E		04
43	300140	RJ Leg				C				04
43	300140	RP Leg					D			04
43	300140	AB Leg		A						04
43	300140	77 Leg			B					04
44	300433	AB Base		A	B	C	D	E	F	01
45	303516	MK Loading door							F	01
45	303516	RH Loading door						E		01
45	303516	RJ Loading door				C				01
45	303516	RP Loading door					D			01
45	303516	AB Loading door		A						01
45	303516	77 Loading door			B					01

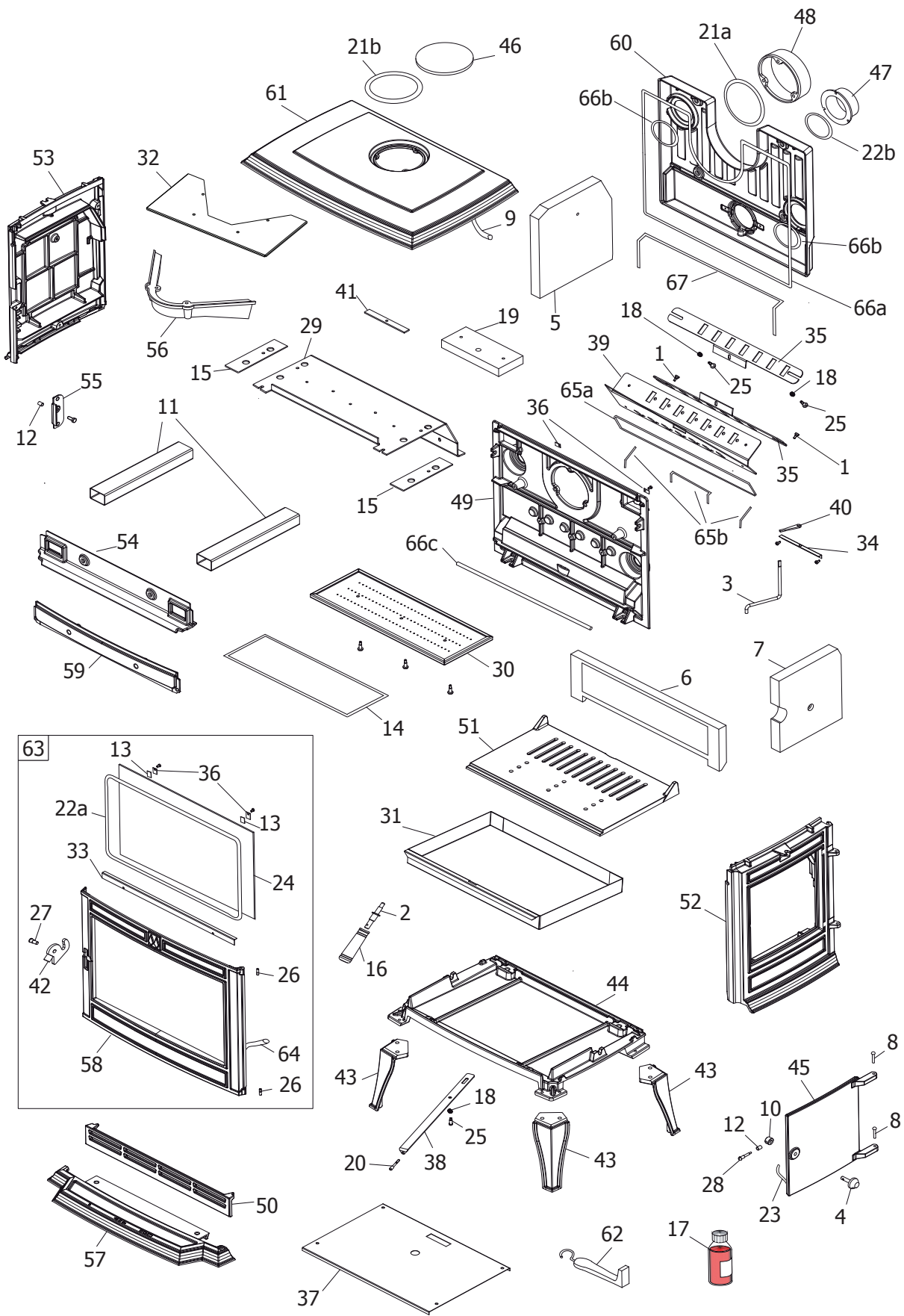

Figure 8 - Stove - exploded view

A = 134 12 07 Y ; B = 134 12 07 L ; C = 134 12 07 B ; D = 134 12 07 E ; E = 134 12 07 P ; F = 1341207 C

N°	Code	Désignation	Type	A	B	C	D	E	F	Qté
46	303718 MK	Blanking plate							F	01
46	303718 RH	Blanking plate						E		01
46	303718 RJ	Blanking plate				C				01
46	303718 RP	Blanking plate					D			01
46	303718 AB	Blanking plate		A						01
46	303718 77	Blanking plate			B					01
47	303826 MK	Flue collar	Ø 153 int.						F	01
47	303826 RH	Flue collar	Ø 153 int.					E		01
47	303826 RJ	Flue collar	Ø 153 int.			C				01
47	303826 RP	Flue collar	Ø 153 int.				D			01
47	303826 AB	Flue collar	Ø 153 int.	A						01
47	303826 77	Flue collar	Ø 153 int.		B					01
48	303859 AB	Flue collar		A	B	C	C	E	F	01
49	306270 AB	Back wall		A	B	C	D	E	F	01
50	307441 AB	Fuel retainer		A	B	C	D	E	F	01
51	309235 AB	Grate		A	B	C	D	E	F	01
52	310740 MK	R. side panel							F	01
52	310740 RH	R. side panel						E		01
52	310740 RJ	R. side panel				C				01
52	310740 RP	R. side panel					D			01
52	310740 AB	R. side panel		A						01
52	310740 77	R. side panel			B					01
53	310835 MK	L. side panel							F	01
53	310835 RH	L. side panel						E		01
53	310835 RJ	L. side panel				C				01
53	310835 RP	L. side panel					D			01
53	310835 AB	L. side panel		A						01
53	310835 77	L. side panel			B					01
54	315616 AB	Air duct		A	B	C	D	E	F	01
55	324503 AB	Sealing plate		A	B	C	D	E	F	01
56	326601 AB	Suppl. flue baffle		A	B	C	D	E	F	01
57	327911 MK	Ash pan guide							F	01
57	327911 RH	Ash pan guide						E		01
57	327911 RJ	Ash pan guide				C				01
57	327911 RP	Ash pan guide					D			01
57	327911 AB	Ash pan guide		A						01
57	327911 77	Ash pan guide			B					01
58	331133 MK	Main door							F	01
58	331133 RH	Main door						E		01
58	331133 RJ	Main door				C				01
58	331133 RP	Main door					D			01
58	331133 AB	Main door		A						01
58	331133 77	Main door			B					01
59	332005 AB	Air duct		A	B	C	D	E	F	01
60	332401 AB	Supplementary plate		A	B	C	D	E	F	01
61	352177 MK	Top plate							F	01
61	352177 RH	Top plate						E		01
61	352177 RJ	Top plate				C				01
61	352177 RP	Top plate					D			01
61	352177 AB	Top plate		A						01
61	352177 77	Top plate			B					01
62	808001 ED	Hand tool		A	B	C	D	E	F	01
63	989017	Complete door		A						01
63	989018	Complete door			B					01
63	989019	Complete door				C				01
63	989020	Complete door					D			01
63	989021	Complete door						E		01
63	989022	Complete door							F	01
64	181614	Rope	Ø 9,5	A	B	C	D	E	F	2,05 m
65a	181632	Rope	Ø 6	A	B	C	D	E	F	1,17 m
65b	181632	Rope	Ø 6	A	B	C	D	E	F	0,37 m
66a	181625	Gasket	Ø 7	A	B	C	D	E	F	2,37 m
66b	181625	Gasket	Ø 7	A	B	C	D	E	F	0,6 m
66c	181625	Gasket	Ø 7	A	B	C	D	E	F	0,5 m
67	181631	Gasket	Ø 10	A	B	C	D	E	F	0,85 m