

• All the parts forming the casing can be rubbed with a slightly damp cloth. If condensation has occurred, do not wait before it has dried out to clean the soiled parts.

Trouble Shooting

Problem	Probable causes	Corrective action
Fire difficult to start Fire goes out	Wood green, too damp or poor quality	- Use the recommended fuel.
	Logs are too big	- To light the fire, use small, very dry twigs. To maintain the fire, use split logs.
	Air starvation	- Open air control(s).
	Insufficient draught	- Open the flue damper* for a while. - Check that the flue is not obstructed, sweep it if necessary. - Seek advice from a chimney specialist.
Fire burns too quickly	Too much draught	- Partially close the air control.
	Excessive draw	- Ensure that the flue damper* is closed. - Install a draught stabiliser. Consult your Dealer.
	Poor quality wood	- Do not continuously burn small wood, sticks, bundles, carpentry offcuts (plywood, pallets), etc.
Smokes when lighting up	The flue damper* is closed	- Open the flue damper*.
	Flue duct is cold	- Burn paper and kindling wood to increase heat.
	Room is in decompression	- In houses equipped with mechanical ventilation, partly open a window until the fire is well established.
Smokes while burning	Draught is insufficient	- Open the flue damper* for a while. - Consult a chimney specialist. - Check that the flue is not obstructed, sweep if necessary
		Down draught
	Room is in decompression	- In houses equipped with CMV, an outside air intake must be installed for the chimney
Low heat output	Incorrect Fuels	- Use the recommended fuel

* when a flue damper is supplied. □

4. List of components

For any order of spare parts, please indicate : model nr., code of the colour, description of the part, code number and colour index of the part.

Example : Insert 634.10.33, door 3C9876.

Qty = quantity per appliance

A = 634.10.33 B = 634.10.34

N°	Code	Description	A	B	Qty
0	988516	Complete fans	A		01
1	100915	Cam pin 12x20 M7	A	B	01
2	100999	Axle	A	B	01
3	106090	Junction block	A		02
4	109148	Wiring system	A		01
5	134253	Bushing	A	B	01
6	134705	Pin 6x4.5	A	B	01
7	134758	Pin 4 x18	A	B	01
8	139243	Switch	A		01
9	142316	Gasket 7x3	A	B	1,36 m
10	158618	Handle	A	B	01
11	162401	Descriptive plate	A		01
11	162434	Descriptive plate		B	01
12	165918	Resistance 1100 ohms	A		01
13	166035	Spring	A	B	01
14	179017	Thermostat	A		01
15	181615	Coramic rope Ø 12	A	B	2,60 m
16	188508	Fan	A		02
17	188802	Glass 60x37x4	A	B	01
18	200176	Base	A	B	01
19	217125	Shell	A	B	01
20	217232	Top plate	A	B	01

21	222547	Flue baffle	A	B	01
23	241600	Support	A	B	02
24	255104	Grate droke	A		01
25	259015	Fixing plate	A	B	04
26	260570	Heat shield	A		02
27	271008	Bracket	A	B	01
28	278004	Plate	A	B	01
29	301538	Door lock	A	B	01
30	303841	Flue collar Ø 180	A	B	01
31	305147	Back wall RH	A	B	01
32	306271	Back wall LH	A	B	01
33	306802	Flue collar Ø 125	A	B	02
34	308293	Fire-dog grate	A	B	01
35	309876	Door	A	B	01
36	310208	Side panel LH	A	B	01
37	313813	Supplementary panell	A	B	01
38	314109	Hinge	A	B	01
39	319734	Grate support	A	B	01
40	320618	Sliding door	A	B	01
41	328110	Top plate	A	B	01
42	330007	Hearth plate	A	B	01
43	413007	Bracket	A	B	01
44	415504	Poker	A	B	01
45	224039	Ash-pan	A	B	01
46	649307	Slide plate	A	B	01
47	808001	Hand tool	A	B	01
48	900937	Knob	A	B	01
49	255202	Grate LH	A		01
50	109228	Cable 0,75 mm2	A		1,50 m
51	269418	Deflector	A	B	01
52	310298	Side panel RH	A	B	01
53	400106	Axle	A	B	01
54	109561	Cap	A		01

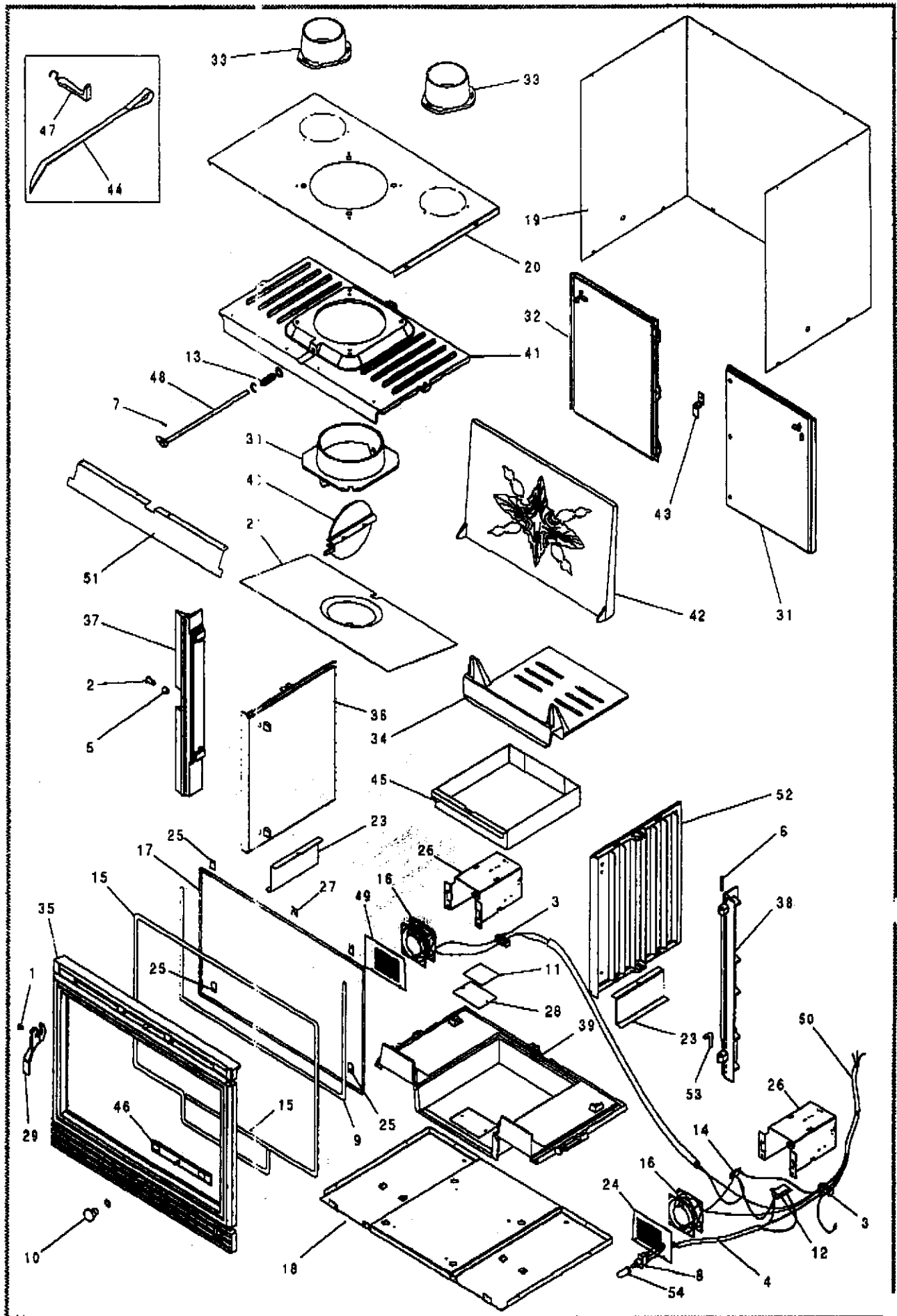

Fig. 15