

# HEAT PUMPS



WARM HOMES



# Clivet Heat Pumps

*Supplied & installed  
across the UK by the  
Firepower network*

---

Clivet have been making heat pumps for over 30 years.

Here at Firepower we distribute renewable heating equipment, including Clivet heat pumps, to installers across the UK. Firepower also draws on over 30 years of experience.

## You already have a heat pump in your kitchen

A fridge is a type of heat pump; it moves (or pumps) heat away from inside your the fridge and into your kitchen, which keeps the fridge cool. A heat pump gathers and moves heat the air outside into your house to keep you warm.







# Firepower

## Installer network with technical support

### *Network Support*

Over 30 years of renewable heating experience in both renovations and new builds, means we can work with you to ensure you have a warm, cosy home, whatever the future holds.

That makes sure that the heat pump installations are both reliable and efficient, as well as helping to quickly overcome any technical issues.



## Boiler Upgrade Scheme

£5000 grant

Clivet Edge heat pumps qualify for the government Boiler Upgrade Scheme grant scheme which provides an upfront £5000 voucher towards the cost of the installation, when you switch to low carbon heating.

There are other eligibility criteria that the project must meet and in addition the heat pump and the installer must be with MCS certified. MCS stands for the

Microgeneration Certification Scheme and helps to demonstrate the quality and reliability of both the heat pump and the installer. The full range of Clivet air source heat pumps are MCS certified.





Yes, they do work when it's cold!

*Clivet air source heat pumps will provide heating at up to 60°C even when it is as cold as minus 10°C outside, and heating at 45°C when it's minus 15°C outside.*

## Heat pumps move heat from one place to another

Air source heat pumps, as their name suggests, take heat from the air outside and use it to warm your home. Even when the air is cold they can still pull more heat from it.

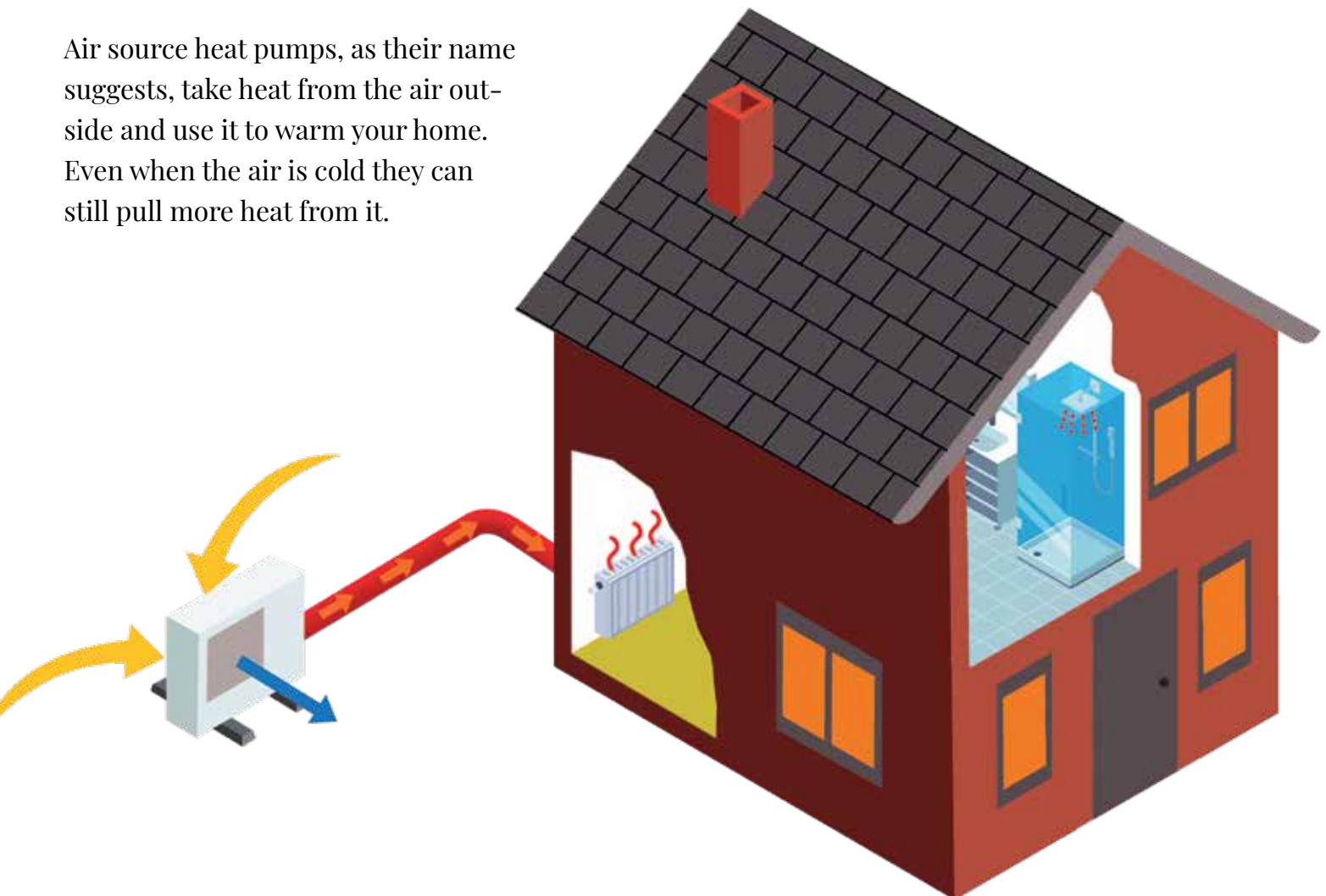



*Despite what some people may say pumps can usually be used to heat older properties.*

*The single-phase pumps will provide up to 18 kWth of heat at 45°C, whilst the three-phase models will provide over 30 kWth, and several pumps can be combined if a higher output is needed.*



*Hot water at up to 60°C*

Clivet heat pumps can provide plenty of hot water for baths and showers, you'll just need a suitable hot water cylinder.







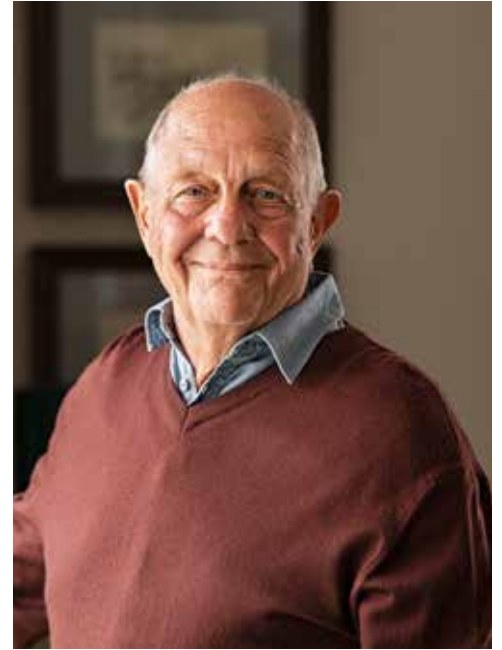

RELIABLE  
HEAT  
NIGHT &  
DAY











A COSY WARM  
HOME & HOT  
WATER WHEN  
YOU NEED IT

SO YOU CAN  
GET ON WITH  
THE MORE  
IMPORTANT  
THINGS IN LIFE



# LOW CARBON

## MORE & MORE ELECTRICITY COMES FROM RENEWABLES

Renewable sources of electricity such as wind turbines and solar has increased, which means that the carbon emissions of the national grid have steadily gone down.

Heat pumps typically provide more than 3 kWh of heat for every kWh of electricity they use. So their carbon emissions are less than a third of the electricity that powers them. If you also sign up to a green electricity tariff from your supplier then the carbon emissions drop even further.

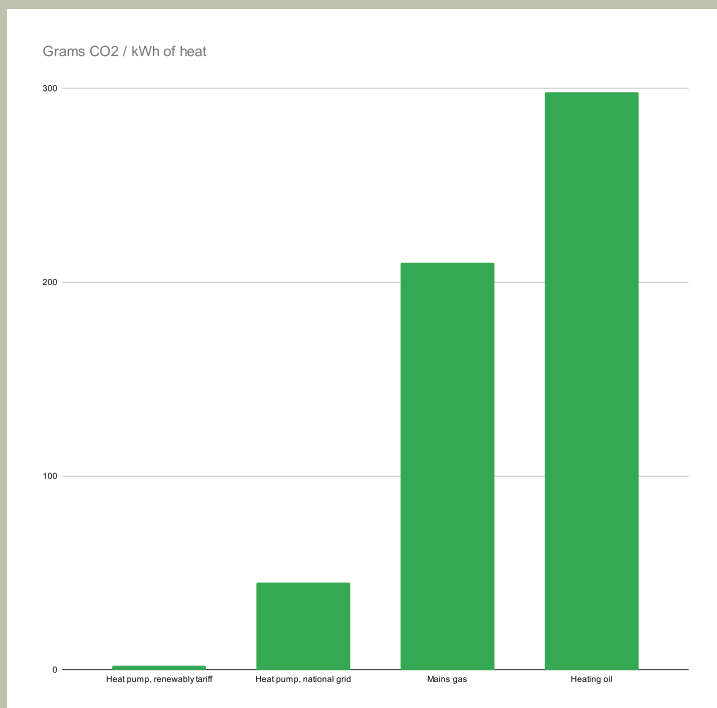





## Underfloor heating and heat pumps, a winning combination

*Underfloor heating works well at low flow temperatures - which means that the heat pump costs less to run.*

### *Heating at 55°C or below*

To run efficiently your heating system needs to be able to work when run at 55°C, and ideally far below that.

If you do not have underfloor heating, or it will be too disruptive or expensive to install then you might just need to upsize your existing radiators, add in some extra radiators, or add some Clivet terminal units.

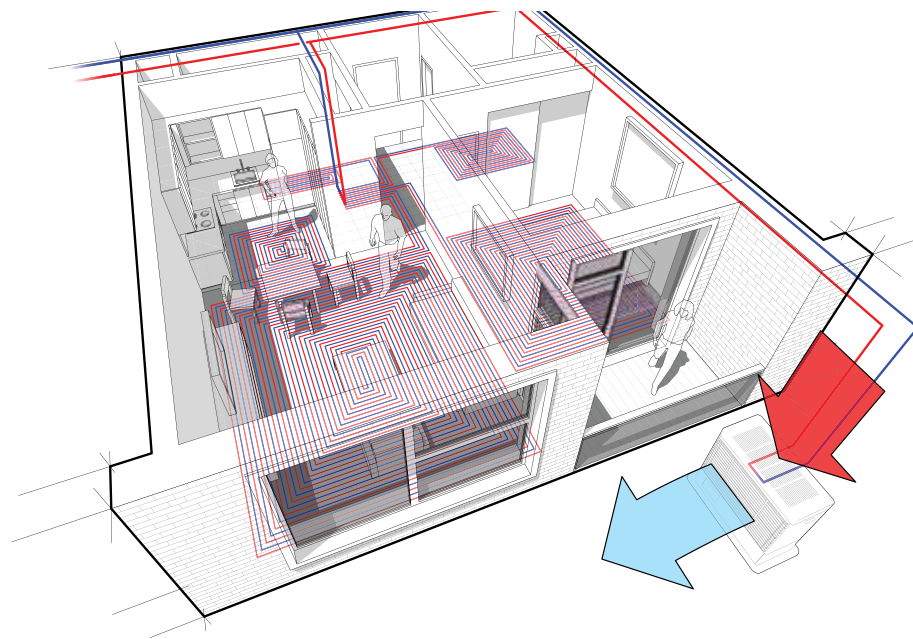



# HEAT AT YOUR FINGERTIPS

Clivet fan assisted heaters can be wall or floor mounted. They typically come on automatically as needed, and can also be remote controlled.

Terminal units can be installed to supplement existing radiators. This creates minimum disruption to your home and lets the heat pump run at exceptional efficiencies, and that means lower running costs.

**SCOP** stands for the Seasonal Coefficiency of Performance, which is a bit of a mouthful.

The SCOP is a measure of how efficient the heat pump is likely to be to run over a whole year.

If a heat pump has a SCOP of 3.5 that means that for every kW of electricity that is used to run the pump, that 3.5 kW of heat will be given to your house.

To be eligible for the Boiler Upgrade Scheme grant air source heat pumps must have a minimum SCOP of 2.8. As you can see Clivet air source heat pumps perform even better than that!



# HEAT OUTPUTS & SCOPs



	Heat Output	SCOP
MKII Edge 21	4.8 kW	3.74
MKII Edge 31	6.7 kW	3.74
MKII Edge 41	8.6 kW	3.73
MKII Edge 61	12.4 kW	3.46
MKII Edge 71	14.1 kW	3.71
MKII Edge 81	16.2 kW	3.68
MKI Edge 21	6.92 kW	3.74
MKI Edge 31	8.81 kW	3.74
MKI Edge 41	10.5 kW	3.74
MKI Edge 61	17.27 kW	3.46
MKI Edge 71	16.36 kW	3.46
MKI Edge 81	18.02 kW	3.46

Heat outputs shown at an outside temperature of 7°C with a flow temperature of 45°C.  
SCOP (Seasonal Coefficient of Performance) shown is also at 45°C



# WOOD PELLET HEATING

For those few times heat pumps aren't suitable, wood pellet boilers can be ideal

Wood pellet boilers automatically turn on and off, and regulate their output, just like a normal oil or gas boiler. You either fill an internal hopper in the boiler with pellets, or have a larger store of pellets outside with an automatic feed mechanism.

We work closely with Klover, an Italian producer of pellet boilers. There are models that are designed to be installed inside the house so you can see the flames, models designed to go in an outbuilding or utility room.

The flagship of the range are the central heating range cooker models which are an excellent upgrade for the oil cookers in farmhouses. At Firepower we worked with Klover to bring out models designed specifically for the UK - adding in a range of colours, plain textured finishes, and of course hob covers.







# Boiler Upgrade Scheme

£5000 grant

Klover wood pellet boilers are all MCS certified and so they also qualify for the Boiler Upgrade Scheme grant.

be off the gas grid rural - which means an area with a population of less than 10,000 people.

In addition to the standard criteria in order to be eligible for a grant towards a biomass boiler your home must also







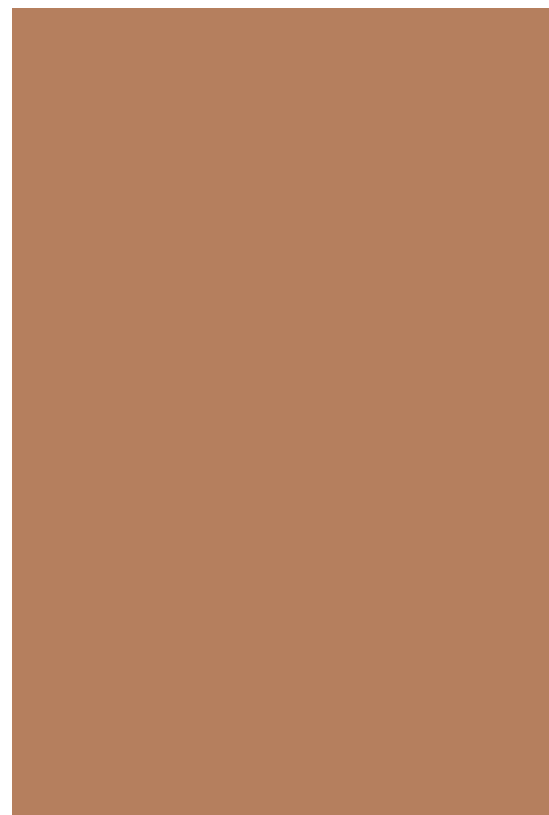

Wood pellet boilers and heat pumps can also be combined with other renewables like solar thermal, solar PV, and storage.





*Get in touch to find out more*

0800 246 1260  
[www.firepower.co.uk](http://www.firepower.co.uk)

**Firepower**